



# Product Specifications

---

## STRUT PRODUCTS



For the most up to date information visit our website:  
[www.taylorpipesupports.ca](http://www.taylorpipesupports.ca)

# PICTORIAL INDEX

# TAYLORSTRUT™



FIG. TS Page 2  
STRUT CHANNEL  
and END CAPS



FIG. 900's Page 3  
STRUT NUTS



Fig. 901 Page 3  
ROD STIFFENER



FIG. 910's Page 3  
STRUT SLIDE NUT

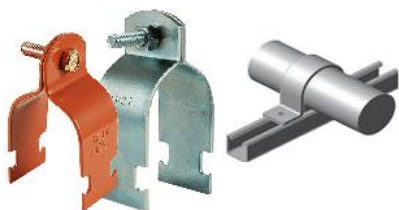

FIG. 910's Page 4  
STRUT PIPE CLAMPS



FIG. 8500 Page 6  
STRUT CUSHION CLAMP



Fig. 920 Page 7  
STRUT CABLE CLAMP



Fig. TY300 Page 8  
4 BEARING TROLLEY ASSY.



FLAT PLATE FITTINGS  
Page 9 - 12



90° ANGLE FITTINGS  
Page 13 - 18



ANGULAR FITTINGS  
Page 19



POST BASES  
Page 20 - 21



U FITTINGS  
Page 22 - 23



WING FITTINGS  
Page 24 - 26



Z FITTINGS  
Page 27 - 29



STRUT BEAM CLAMPS  
Page 30 - 32



MISCELLANEOUS FITTINGS  
Page 33 - 34

## STRUT CHANNEL

**SIZE RANGE:** 1" and 1 5/8"

**MATERIAL:** Cold Rolled Steel

**FINISH:** Pre-Galvanized

**SERVICE:** Various metal framing and fastening applications.

**ORDERING:** Specify product #, profile, finish and length.

**ALSO AVAILABLE IN:**

Other Sizes & Lengths, Stainless Steel and Aluminum

Figure

TS



Profile #	SPECIFICATION DATA				LBS / FT	Standard Length	Bundle QTY
	Profile (H x W)	Configuration	Material	Finish			
TS2-PG	1" x 1 5/8"	SOLID	12Ga	Pre -Galv.	1.44	10 Ft	50
TS2HS-PG	1" x 1 5/8"	HALF SLOT	12Ga	Pre -Galv.	1.36	10 Ft	50
TS2-SS6	1" x 1 5/8"	SOLID	12Ga	Stainless 316	1.44	10 Ft	50
TS4-PG	1 5/8" x 1 5/8"	SOLID	12Ga	Pre -Galv.	1.90	10 Ft	50
TS4HS-PG	1 5/8" x 1 5/8"	HALF SLOT	12Ga	Pre -Galv.	1.82	10 Ft	50
TS4-SS4	1 5/8" x 1 5/8"	SOLID	12Ga	Stainless 304	1.90	10 Ft	50
TS4HS-SS4	1 5/8" x 1 5/8"	HALF SLOT	12Ga	Stainless 304	1.82	10 Ft	50
TS4-SS6	1 5/8" x 1 5/8"	SOLID	12Ga	Stainless 316	1.90	10 Ft	50
TS4HS-SS6	1 5/8" x 1 5/8"	HALF SLOT	12Ga	Stainless 316	1.82	10 Ft	50
SPECIFICATIONS OF OTHER SIZES AND PROFILES ALSO AVAILABLE (HALF SLOT CONFIGURATION - HOLES at 2" CENTERS, 1 1/8" LONG, 9/16" WIDE)							

END CAPS	
Size	For Profile
EC100	1" x 1 5/8"
EC158	1 5/8" x 1 5/8"

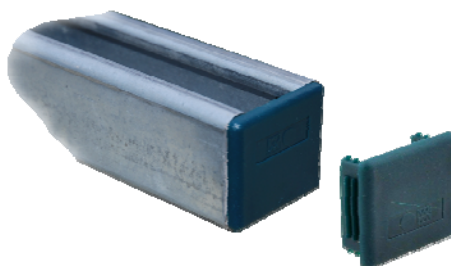

**Strut Nut - NO SPRING**
**900NS**

Standard Finish: ELECTRO-PLATED ZINC  
 \*All STAINLESS STEEL = Type 316L (1/4", 3/8" & 1/2" ONLY)

PART #	THREAD SIZE	MAT. THICKNESS	WT. PER 100
900NS 1/4	1/4-20	1/4"	7 #
900NS 3/8	3/8-16	3/8"	9 #
900NS 1/2	1/2-13	3/8"	9 #
900NS 5/8	5/8-11	3/8"	17 #
900NS 3/4	3/4-10	3/8"	14 #

**Strut Nut - SHORT SPRING**
**900SH**

Standard Finish: ELECTRO-PLATED ZINC  
 \*All STAINLESS STEEL = Type 316L

PART #	THREAD SIZE	MAT. THICKNESS	WT. PER 100
900SH 1/4	1/4-20	1/4"	7 #
900SH 3/8	3/8-16	3/8"	9 #
900SH 1/2	1/2-13	3/8"	9 #

**Strut Nut - REGULAR SPRING**
**900RG**

Standard Finish: ELECTRO-PLATED ZINC  
 \*All STAINLESS STEEL = Type 316L (1/4", 3/8" & 1/2" ONLY)

PART #	THREAD SIZE	MAT. THICKNESS	WT. PER 100
900RG 1/4	1/4-20	1/4"	7 #
900RG 5/16	5/16-18	1/4"	7 #
900RG 3/8	3/8-16	3/8"	9 #
900RG 1/2	1/2-13	3/8"	9 #
900RG 5/8	5/8-11	1/2"	18 #
900RG 3/4	3/4-10	1/2"	16 #
900RG 7/8	7/8-9	1/2"	14 #

**ROD STIFFENER**
**901**

For 3/8" through 5/8" ATR  
 Strut ordered separately  
 Standard Finish: Zinc Plated

**Strut Slide Nut**
**902W**

Standard Finish: ELECTRO-PLATED ZINC

	PART #	THREAD SIZE	BOX QTY.	WT. PER 100
Imperial	902W 1/4	1/4-20	20	13 #
	902W 3/8	3/8-16	20	14 #
	902W 1/2	1/2-13	20	14 #
Metric	902W M8	M8-1.25	20	13 #
	902W M10	M10-1.5	20	14 #
	902W M12	M12-1.75	20	14 #

STANDARD FINISHES: Zinc Plated  
 ALSO AVAILABLE IN: STAINLESS STEEL



**Zinc Strut Pipe Clamp - RIGID**

**910R**



\*Stainless Steel 910R 2 - 910R 8 = 14 GA.

PART No.	PIPE SIZE	O.D.	*GAUGE	Design Load	Wt. Per 100	Std. Pkg.
910R 3/8	3/8	0.675	16 GA	400 #	9 #	100
910R 1/2	1/2	0.840	16 GA	400 #	14 #	100
910R 3/4	3/4	1.050	14 GA	600 #	17 #	100
910R 1	1	1.315	14 GA	600 #	18 #	100
910R 1 1/4	1 1/4	1.660	14 GA	600 #	22 #	100
910R 1 1/2	1 1/2	1.900	14 GA	600 #	23 #	100
910R 2	2	2.375	14 GA	600 #	27 #	50
910R 2 1/2	2 1/2	2.875	12 GA	800 #	40 #	25
910R 3	3	3.500	12 GA	800 #	50 #	25
910R 3 1/2	3 1/2	4.000	12 GA	800 #	52 #	25
910R 4	4	4.500	12 GA	800 #	54 #	25
910R 5	5	5.563	12 GA	800 #	72 #	20
910R 6	6	6.625	12 GA	800 #	102 #	25
910R 8	8	8.625	12 GA	800 #	104 #	25

ALSO AVAILABLE IN: Stainless Steel (316 SS)

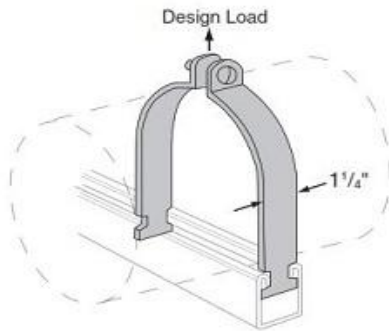

**Zinc Strut Pipe Clamp - EMT**

**910E**

PART No.	PIPE SIZE	O.D.	GAUGE	Design Load	Wt. Per 100	Std. Pkg.
910E 3/8	3/8	0.577	16 GA	400 #	7 #	100
910E 1/2	1/2	0.706	16 GA	400 #	12 #	100
910E 3/4	3/4	0.922	16 GA	400 #	14 #	100
910E 1	1	1.163	14 GA	600 #	16 #	100
910E 1 1/4	1 1/4	1.510	14 GA	600 #	20 #	100
910E 1 1/2	1 1/2	1.740	14 GA	600 #	21 #	100
910E 2	2	2.197	14 GA	600 #	23 #	50

ALSO AVAILABLE IN: Stainless Steel (316 SS)

DESIGN LOAD INCLUDES A SAFETY FACTOR OF 5.0  
(safety factor = ratio of ultimate load to the design load)

Zinc plated hex head screw and nut included.

**Copper-Gard Strut Pipe Clamp - COPPER TUBING**

**910C**



Copper plated hex head screw and nut included.

PART No.	PIPE SIZE	O.D.	GAUGE	Design Load	Wt. Per 100	Std. Pkg.
910C 3/8	3/8	0.500	16 GA	400 #	9 #	100
910C 1/2	1/2	0.625	16 GA	400 #	14 #	100
910C 3/4	3/4	0.875	16 GA	400 #	16 #	100
910C 1	1	1.125	14 GA	600 #	18 #	100
910C 1 1/4	1 1/4	1.375	14 GA	600 #	22 #	100
910C 1 1/2	1 1/2	1.625	14 GA	600 #	23 #	100
910C 2	2	2.125	14 GA	600 #	25 #	100
910C 2 1/2	2 1/2	2.625	12 GA	800 #	40 #	50
910C 3	3	3.125	12 GA	800 #	50 #	50
910C 3 1/2	3 1/2	3.625	12 GA	800 #	52 #	25
910C 4	4	4.125	12 GA	800 #	54 #	25
910C 5	5	5.125	12 GA	800 #	72 #	25
910C 6	6	6.125	12 GA	800 #	102 #	25

DESIGN LOAD INCLUDES A SAFETY FACTOR OF 5.0  
(safety factor = ratio of ultimate load to the design load)

**ALSO AVAILABLE IN: STAINLESS STEEL and ALUMINUM**

**Strut Cushion Clamp**
**8500**

SIZES: 1/4" OD through 4 1/8" OD

MATERIAL: Electro-galvanized steel with thermoplastic insulating liner.

ALSO AVAILABLE IN: Stainless Steel (304 SS) and Stainless Steel (316 SS)

SERVICE: Prevents shock, vibration, corrosion, and metal contact in strut fastening applications.

PART No.	Copper Tube	IPS	Weight Each (LBS)	Pkg. Qty.
<b>8500 - 1/4OD</b>			0.11	25
<b>8500 - 3/8OD</b>	1/4"		0.11	25
<b>8500 - 1/2OD</b>	3/8"		0.11	25
<b>8500 - 5/8OD</b>	1/2"		0.12	25
<b>8500 - 3/4OD</b>	5/8"		0.13	25
<b>8500 - 7/8OD</b>	3/4"	1/2"	0.20	25
<b>8500 - 1OD</b>			0.21	25
<b>8500 - 1 1/8OD</b>	1"	3/4"	0.27	25
<b>8500 - 1 1/4OD</b>			0.29	10
<b>8500 - 1 3/8OD</b>	1 1/4"	1"	0.31	10
<b>8500 - 1 1/2OD</b>			0.35	10
<b>8500 - 1 5/8OD</b>	1 1/2"	1 1/4"	0.40	10
<b>8500 - 1 7/8OD</b>		1 1/2"	0.42	10
<b>8500 - 2OD</b>			0.46	10
<b>8500 - 2 1/8OD</b>	2"		0.49	10
<b>8500 - 2 3/8OD</b>		2"	0.60	10
<b>8500 - 2 5/8OD</b>	2 1/2"		0.62	10
<b>8500 - 3 1/8OD</b>	3"		0.65	10
<b>8500 - 4 1/8OD</b>	4"		0.90	10

## #46 HOLD DOWN CLAMP

**Finish:** Bare Metal

*alt: Zinc Plated, Hot Dipped Galvanized*

**Material:** Carbon Steel

*alt: Stainless Steel 304 and 316*

**Approvals:** Complies with MSS SP-58  
and SP-69 (Type 26).

**Recommended:** Designed to steady a horizontal run  
of pipe against a perpendicular  
section of strut channel or any  
other flat surface

**Notes:**

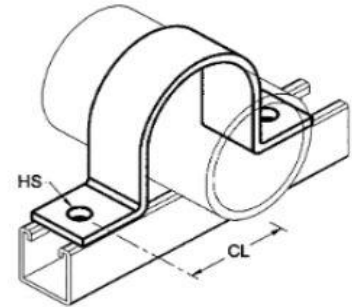
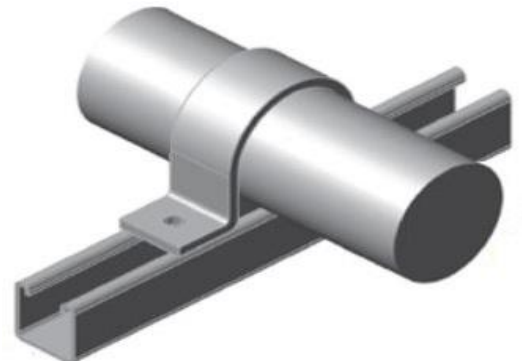

Iron Pipe Size	SPECIFICATION DATA			Weight Each (Lbs)
	HS (Hole Size)	CL	MATERIAL	
1/2	5/16	15/16	1/8 x 1 5/8	0.23
3/4	5/16	1	1/8 x 1 5/8	0.26
1	5/16	1 1/8	1/8 x 1 5/8	0.31
1 1/4	5/16	1 5/16	1/8 x 1 5/8	0.35
1 1/2	5/16	1 7/16	1/8 x 1 5/8	0.39
2	7/16	2 1/8	1/4 x 1 5/8	0.94
2 1/2	7/16	2 3/8	1/4 x 1 5/8	1.14
3	7/16	2 11/16	1/4 x 1 5/8	1.33
3 1/2	7/16	2 15/16	1/4 x 1 5/8	1.52
4	9/16	3 3/16	1/4 x 1 5/8	1.76
5	9/16	3 3/4	1/4 x 1 5/8	1.98
6	9/16	4 1/4	1/4 x 1 5/8	2.25
8	9/16	5 5/16	1/4 x 1 3/4	3.10
10	9/16	6 5/16	1/4 x 1 3/4	3.70
12	9/16	7 5/16	1/4 x 1 3/4	4.40
14	15/16	8 7/8	3/8 x 1 3/4	7.80
16	15/16	9 7/8	3/8 x 1 3/4	8.70
18	15/16	11 3/4	1/2 x 1 3/4	13.20
20	15/16	12 3/4	1/2 x 1 3/4	14.50
24	15/16	14 3/4	1/2 x 1 3/4	17



## STRUT CLAMPS

### Strut 1 Piece Adjustable Cable Clamp

**920**

PART No.	O.D. RANGE	GAUGE	Wt. Per 100	Std. Pkg.
920-055	0.050 - 0.550	16 GA.	8	100
920-081	0.250 - 0.840	16 GA.	9	100
920-110	0.810 - 1.100	16 GA.	12	100
920-135	0.850 - 1.350	14 GA.	14	100
920-175	1.250 - 1.750	14 GA.	21	100
920-205	1.550 - 2.050	12 GA.	30	50
920-250	2.000 - 2.500	12 GA.	35	50
920-300	2.500 - 3.000	12 GA.	39	50
920-325	2.750 - 3.250	12 GA.	41	50
920-375	3.250 - 3.750	12 GA.	47	25
920-425	3.750 - 4.250	12 GA.	54	25
920-475	4.250 - 4.750	12 GA.	58	25

\*Stainless Steel 920-205 to 920-475 = 14 GA.

STANDARD FINISHES: Zinc Plated

ALSO AVAILABLE IN: STAINLESS STEEL and ALUMINUM



## TWO BEARING TROLLEY ASSEMBLY

**MATERIAL:** Carbon Steel Plate  
Stainless Steel Ball Bearings- Sealed

**FINISH:** Electro-Plated Zinc

**SERVICE:** Designed to roll inside strut channel.  
Not for continuous cycling applications.

**ORDERING:** Figure number, name and finish.

PRODUCT #	DESIGN LOAD		RPM	PLATE MATERIAL	BOX QTY.
	LBS	kN			
TY100	150	(.67)	@600	1/4" x 1 1/4"	50
	225	(1.00)	@300		
	437	(1.94)	@100		

Figure

# TY100



Safety Factor of 2.5

Wt/C 48Lbs

## FOUR BEARING TROLLEY ASSEMBLY

**MATERIAL:** Carbon Steel Plate  
Stainless Steel Ball Bearings- Sealed

**FINISH:** Electro-Plated Zinc

**SERVICE:** Designed to roll inside strut channel.  
Not for continuous cycling applications.

**ORDERING:** Figure number, name and finish.

PRODUCT #	DESIGN LOAD		RPM	PLATE MATERIAL	BOX QTY.
	LBS	kN			
TY300	300	(1.33)	@600	1/4" x 3 1/2"	25
	450	(2.00)	@300		
	600	(2.67)	@100		

Figure

# TY300



Safety Factor of 2.5

Wt/C 110Lbs

**Square Washer**
**FP100**

Std Stocking Item

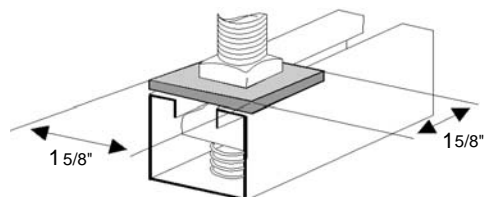

PART No.	ROD SIZE	Hole Dia.	Wt. Per 100
FP100-1/4	1/4"	5/16"	19#
FP100-5/16	5/16"	3/8"	18#
FP100-3/8	3/8"	7/16"	18#
FP100-1/2	1/2"	9/16"	17#
FP100-5/8	5/8"	11/16"	16#
FP100-3/4	3/4"	13/16"	15#

 Std. Pkg.  
100 Pcs.

**No-Turn Washer**
**FP101**

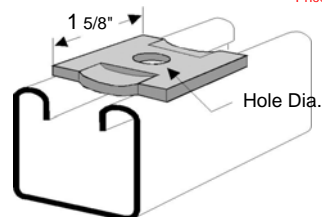
 Non-Stock Item  
Priced on Application

PART No.	ROD SIZE	Hole Dia.	Wt. Per 100
FP101-1/4	1/4"	5/16"	19#
FP101-5/16	5/16"	3/8"	18#
FP101-3/8	3/8"	7/16"	18#
FP101-1/2	1/2"	9/16"	17#
FP101-5/8	5/8"	11/16"	16#
FP101-3/4	3/4"	13/16"	15#

 Std. Pkg.  
100 Pcs.

**Two-Hole Splice Plate**
**FP200**

Std Stocking Item

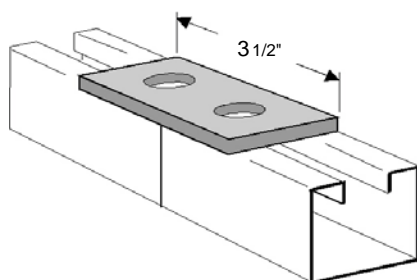
 Wt./C 37 Lbs.  
Std. Pkg. 50 Pcs.

**Two-Hole Splice Plate**
**FP201**

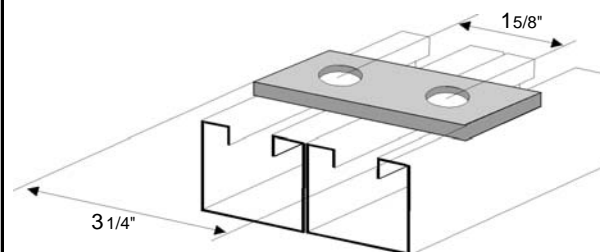
 Non-Stock Item  
Priced on Application

 Wt./C 34 Lbs.  
Std. Pkg. 50 Pcs.

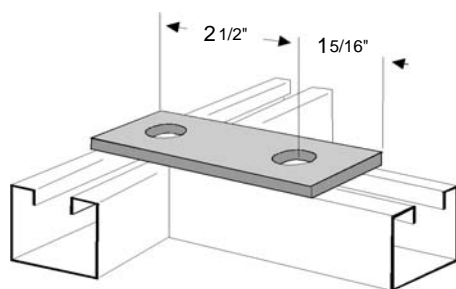
**Two-Hole Splice Plate**
**FP202**

 Non-Stock Item  
Priced on Application

 Wt./C 50 Lbs.  
Std. Pkg. 25 Pcs.

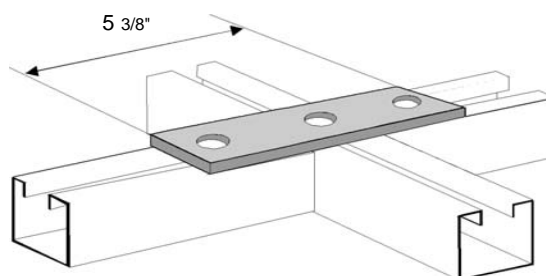
**Three-Hole Splice Plate**
**FP300**

Std Stocking Item



 Wt./C 55 Lbs.  
Std. Pkg. 25 Pcs.

**FITTING SPECIFICATIONS** (unless noted): Hole Size-9/16" Diameter; Hole Spacing-13/16" from end and 1 7/8" on center.  
Width-1 5/8"; Thickness 1/4"

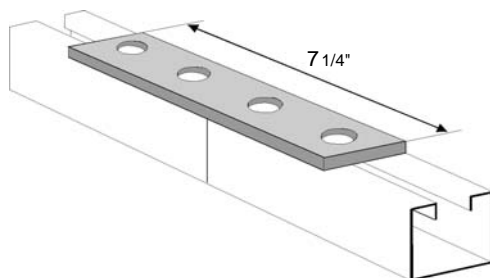
**FINISHES AVAILABLE:** Zinc Plated, Hot-Dipped Galvanized & Stainless Steel

**Four Hole Splice Plate**
**FP400**

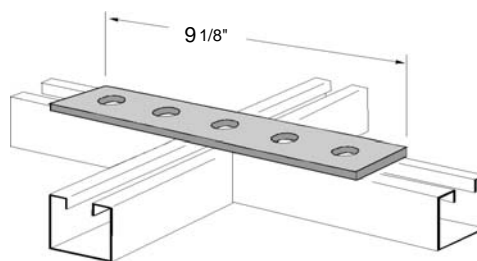
Wt./C 76 Lbs.  
Std. Pkg. 25 Pcs.

**Five Hole Splice Plate**
**FP401**

Wt./C 96 Lbs.  
Std. Pkg. 20 Pcs.

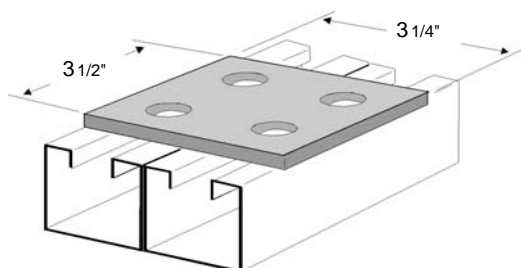
**Four Hole Splice Plate**
**FP402**

Wt./C 73 Lbs.  
Std. Pkg. 25 Pcs.

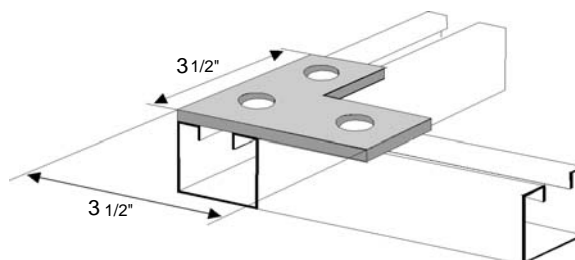
**Three Hole Corner Plate**
**FP500**

Wt./C 56 Lbs.  
Std. Pkg. 25 Pcs.

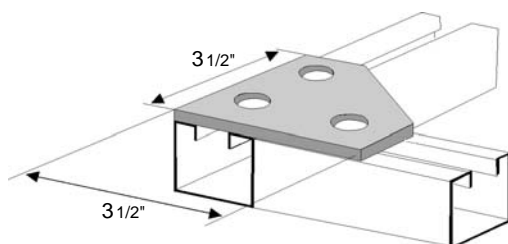
**Three Hole Corner Gusset**
**FP501**

Wt./C 70 Lbs.  
Std. Pkg. 25 Pcs.

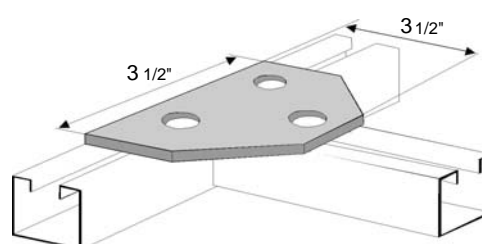
**Three Hole Tee Gusset**
**FP502**

Wt./C 70 Lbs.  
Std. Pkg. 25 Pcs.

**FITTING SPECIFICATIONS** (*unless noted*): Hole Size-9/16" Diameter; Hole Spacing-13/16" from end and 1 7/8" on center.  
Width-1 5/8"; Thickness 1/4"

**STANDARD FINISHES:** Zinc Plated

**ALSO AVAILABLE IN:** HDG and STAINLESS STEEL

**Four-Hole Tee Plate**
**FP600**

Std Stocking Item

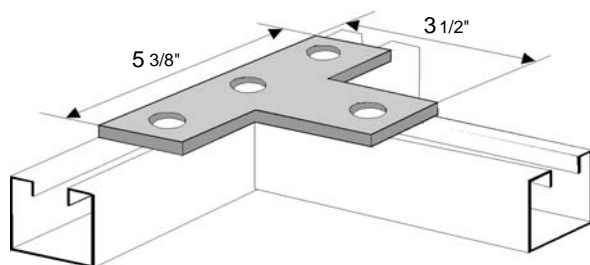

 Wt./C 75 Lbs.  
Std. Pkg. 20 Pcs.

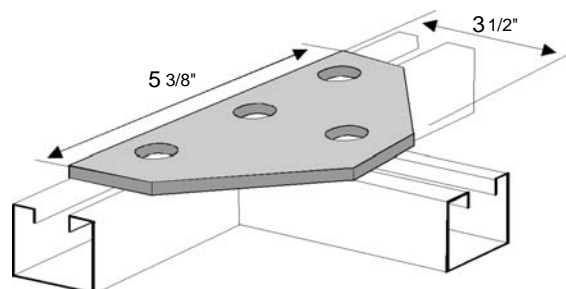
**Four-Hole Tee Gusset**
**FP601**

 Non-Stock Item  
Priced on Application

 Wt./C 100 Lbs.  
Std. Pkg. 25 Pcs.

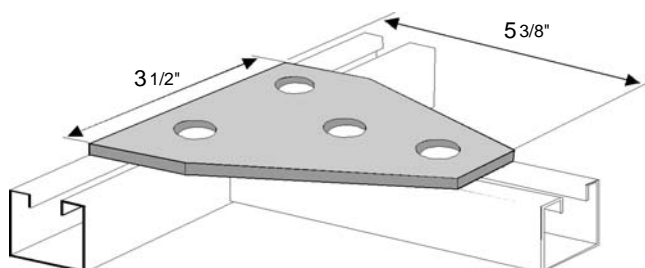
**Four-Hole Tee Gusset**
**FP602**

Std Stocking Item

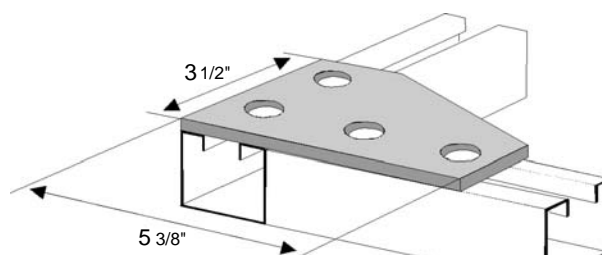

 Wt./C 100 Lbs.  
Std. Pkg. 20 Pcs.

**Four-Hole Corner Gusset**
**FP603**

 Non-Stock Item  
Priced on Application

 Wt./C 102 Lbs.  
Std. Pkg. 25 Pcs.

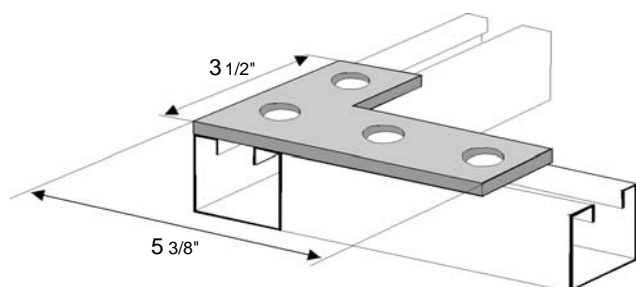
**Four-Hole Corner Plate**
**FP604**

Std Stocking Item

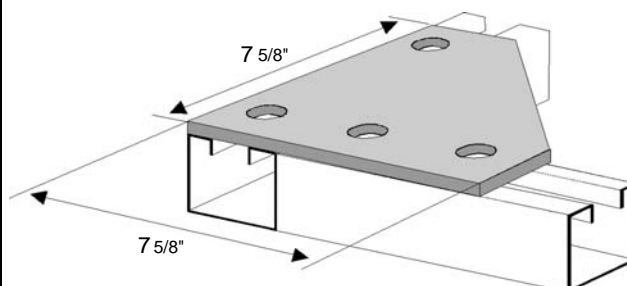

 Wt./C 75 Lbs.  
Std. Pkg. 25 Pcs.

**Four-Hole Corner Gusset**
**FP605**

 Non-Stock Item  
Priced on Application

 Wt./C 273 Lbs.  
Std. Pkg. 10 Pcs.

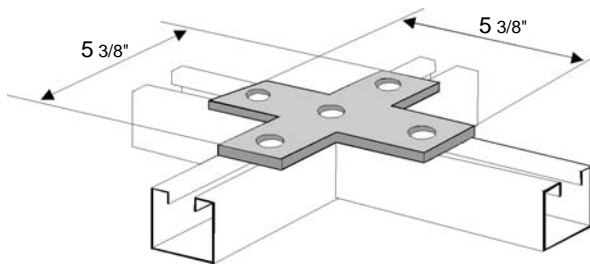
**FITTING SPECIFICATIONS** (unless noted): Hole Size-9/16" Diameter; Hole Spacing-13/16" from end and 1 7/8" on center.  
Width-1 5/8"; Thickness 1/4"

**FINISHES AVAILABLE:** Zinc Plated, Hot-Dipped Galvanized & Stainless Steel

**Five Hole Cross Plate**
**FP700**

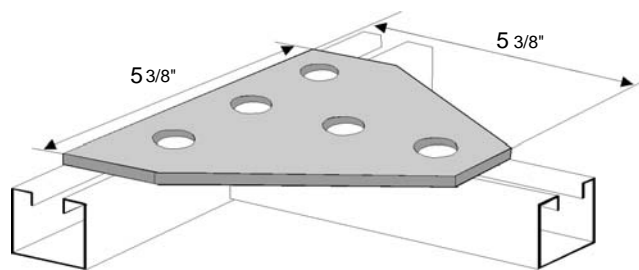
Wt./C 100 Lbs.  
Std. Pkg. 10 Pcs.

**Five Hole Tee Gusset**
**FP701**

Wt./C 143 Lbs.  
Std. Pkg. 20 Pcs.

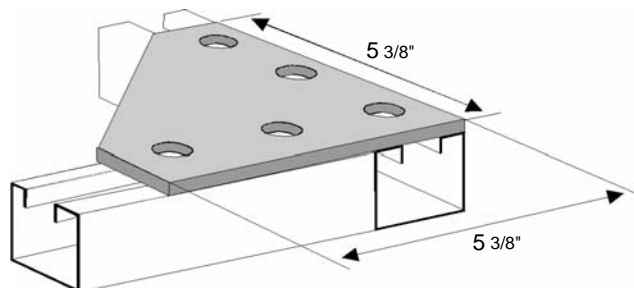
**Five Hole Corner Gusset**
**FP702**

Wt./C 145 Lbs.  
Std. Pkg. 20 Pcs.

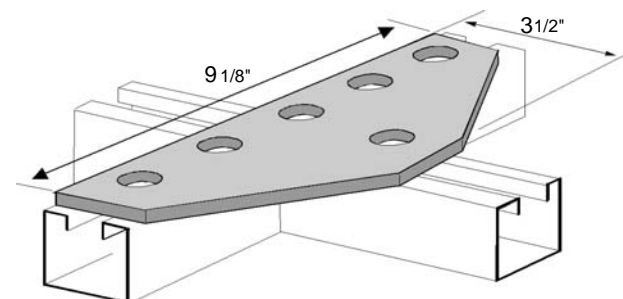
**Six Hole Tee Gusset**
**FP800**

Wt./C 149 Lbs.  
Std. Pkg. 20 Pcs.

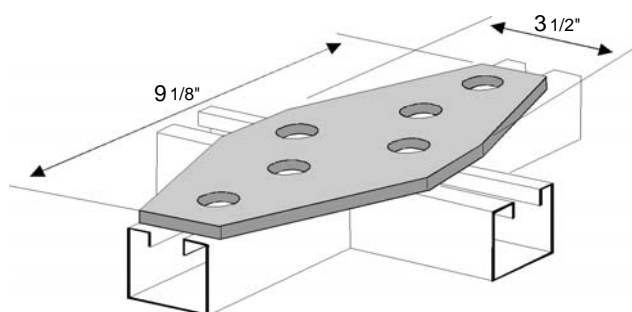
**Six Hole Cross Gusset**
**FP801**

Wt./C 166 Lbs.  
Std. Pkg. 20 Pcs.

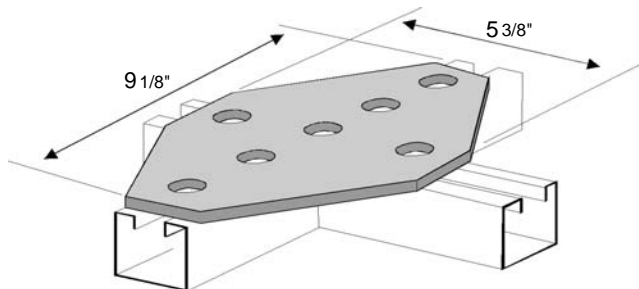
**Seven Hole Cross Gusset**
**FP900**

Wt./C 232 Lbs.  
Std. Pkg. 15 Pcs.

**FITTING SPECIFICATIONS** (*unless noted*): Hole Size-9/16" Diameter; Hole Spacing-13/16" from end and 1 7/8" on center.  
Width-1 5/8"; Thickness 1/4"

**STANDARD FINISHES:** Zinc Plated

**ALSO AVAILABLE IN:** HDG and STAINLESS STEEL

**One-Hole Corner Angle**
**AF100**

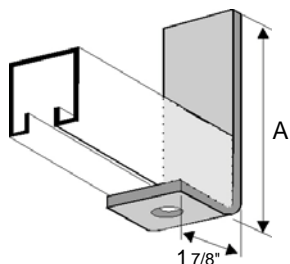
 Non-Stock Item  
Priced on Application

Std. Pkg. 25 Pcs.

PART No.	Dim. A	Wt. Per 100
AF100-1	3 7/8	60#
AF100-2	5 7/8	85#
AF100-3	7 7/8	107#
AF100-4	9 7/8	129#

**Two-Hole Corner Angle**
**AF101**

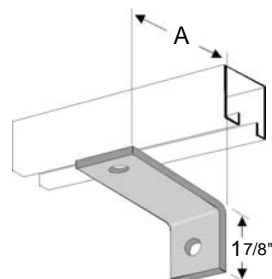
 Non-Stock Item  
Priced on Application

Std. Pkg. 50 Pcs.

PART No.	Dim. A	Wt. Per 100
AF101-1	3	48#
AF101-2	3 1/2	53#
AF101-3	4	60#

**Two-Hole Corner Angle**
**AF200**

Std Stocking Item

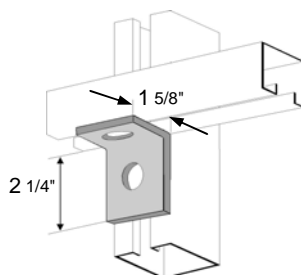
 Wt./C 37 Lbs.  
Std. Pkg. 50 Pcs.

**Two-Hole Corner Angle**
**AF201**

Std Stocking Item

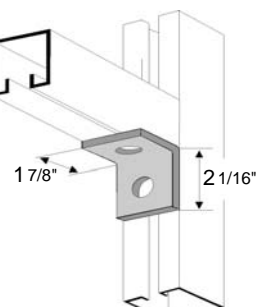
 Wt./C 37 Lbs.  
Std. Pkg. 50 Pcs.

**Three-Hole Corner Angle**
**AF300**

Std Stocking Item

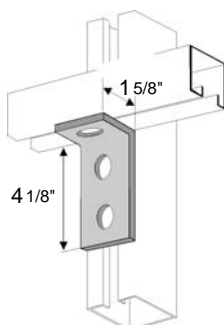
 Wt./C 56 Lbs.  
Std. Pkg. 25 Pcs.

**Three-Hole Corner Angle**
**AF301**

Std Stocking Item

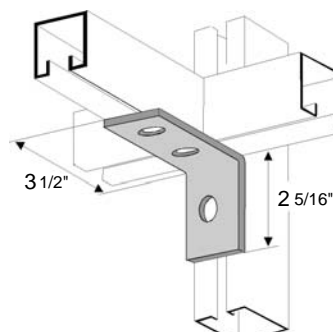
 Wt./C 56 Lbs.  
Std. Pkg. 25 Pcs.

**FITTING SPECIFICATIONS** (unless noted) : Hole Size-9/16" Diameter; Hole Spacing-13/16" from end and 1 7/8" on center.  
Width-1 5/8"; Thickness 1/4"

**FINISHES AVAILABLE:** Zinc Plated, Hot-Dipped Galvanized & Stainless Steel



**Three-Hole Corner Angle**
**AF302**

Std Stocking Item

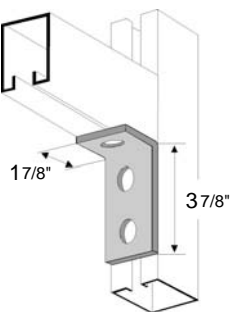

 Wt./C 56 Lbs.  
Std. Pkg. 25 Pcs.

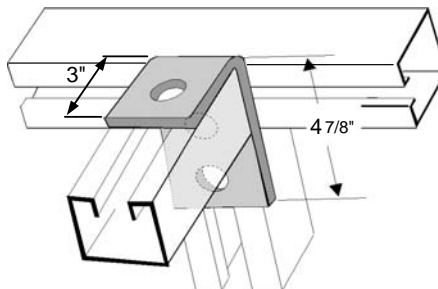
**Three-Hole Corner Angle**
**AF303**

 Non-Stock Item  
Priced on Application

 Wt./C 78 Lbs.  
Std. Pkg. 25 Pcs.

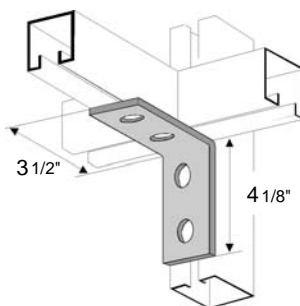
**Four-Hole Corner Angle**
**AF400**

Std Stocking Item



 Wt./C 78 Lbs.  
Std. Pkg. 20 Pcs.

**Four-Hole Corner Angle**
**AF401**

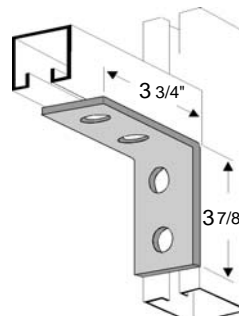
Std Stocking Item

 Wt./C 76 Lbs.  
Std. Pkg. 20 Pcs.

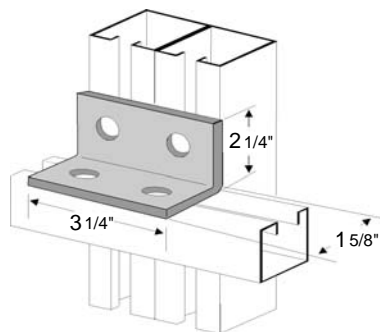
**Four-Hole Corner Angle**
**AF402**

 Non-Stock Item  
Priced on Application

 Wt./C 73 Lbs.  
Std. Pkg. 20 Pcs.

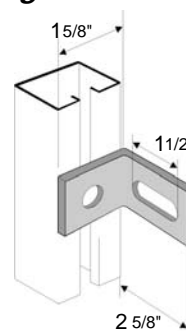
**Two-Hole Adjustable  
Corner Angle**
**AF210**

 Non-Stock Item  
Priced on Application

 Wt./C 38 Lbs.  
Std. Pkg. 25 Pcs.

FITTING SPECIFICATIONS (unless noted): Hole Size-9/16" Diameter; Hole Spacing-13/16" from end and 1 7/8" on center.  
Width-1 5/8"; Thickness 1/4"

FINISHES AVAILABLE: Zinc Plated, Hot-Dipped Galvanized & Stainless Steel

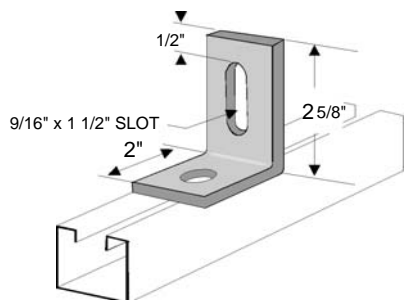
**Two-Hole Adjustable  
Corner Angle**
**AF211**

 Non-Stock Item  
Priced on Application

 Wt./C 41 Lbs.  
Std. Pkg. 25 Pcs.

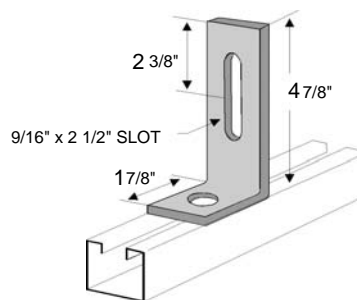
**Two-Hole Adjustable  
Corner Angle**
**AF212**

 Non-Stock Item  
Priced on Application

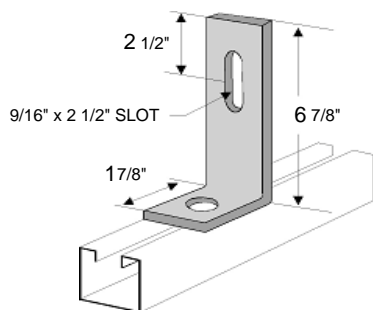
 Wt./C 58 Lbs.  
Std. Pkg. 25 Pcs.

**Two-Hole Adjustable  
Corner Angle**
**AF213**

 Non-Stock Item  
Priced on Application

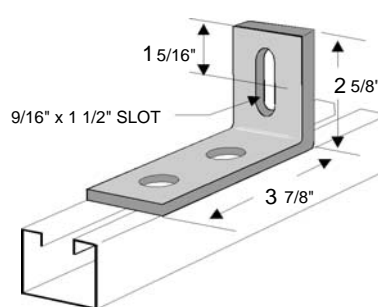
 Wt./C 58 Lbs.  
Std. Pkg. 25 Pcs.

**Three-Hole Adjustable  
Corner Angle**
**AF214**

 Non-Stock Item  
Priced on Application

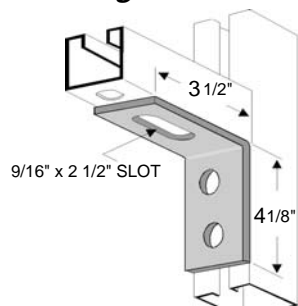
 Wt./C 61 Lbs.  
Std. Pkg. 25 Pcs.

**Three-Hole Adjustable  
Corner Angle**
**AF215**

 Non-Stock Item  
Priced on Application

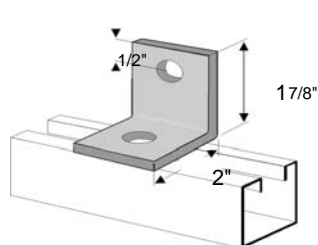
 Wt./C 68 Lbs.  
Std. Pkg. 20 Pcs.

**Two-Hole Bus Duct Angle**
**AF219**

 Non-Stock Item  
Priced on Application

 Wt./C 37 Lbs.  
Std. Pkg. 25 Pcs.

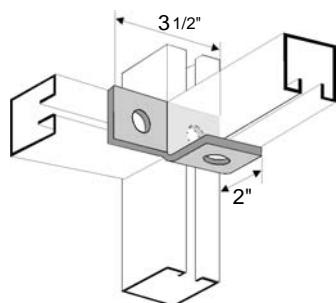
**FITTING SPECIFICATIONS** (unless noted) : Hole Size-9/16" Diameter; Hole Spacing-13/16" from end and 1 7/8" on center.  
Width-1 5/8"; Thickness 1/4"

**FINISHES AVAILABLE:** Zinc Plated, Hot-Dipped Galvanized & Stainless Steel

**Three Hole Offset Bent  
Angle**
**AF310**

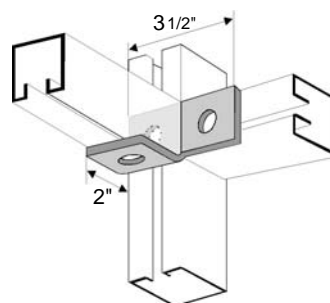
Wt./C 65 Lbs.  
Std. Pkg. 25 Pcs.

**Three Hole Offset Bent  
Angle**
**AF311**

Wt./C 65 Lbs.  
Std. Pkg. 25 Pcs.

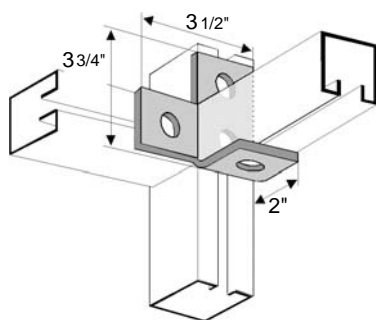
**Four Hole Offset Bent  
Angle**
**AF410**

Wt./C 76 Lbs.  
Std. Pkg. 20 Pcs.

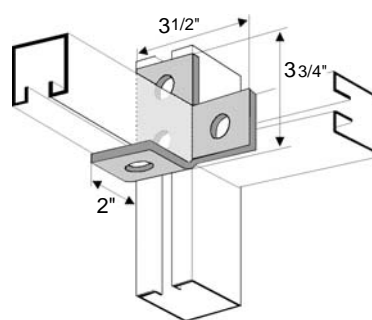
**Four Hole Offset Bent  
Angle**
**AF411**

Wt./C 76 Lbs.  
Std. Pkg. 20 Pcs.

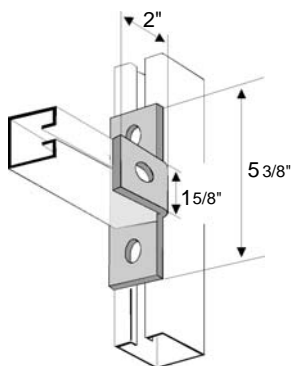
**Four Hole Offset Bent  
Tee**
**AF415**

Wt./C 76 Lbs.  
Std. Pkg. 20 Pcs.

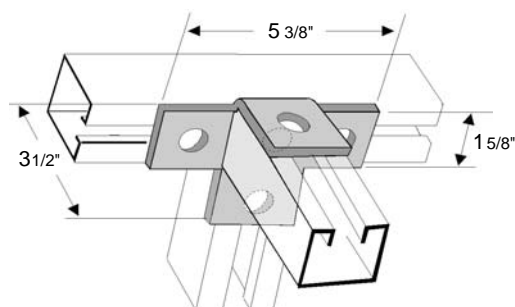
**Five Hole Offset Bent  
Tee**
**AF510**

Wt./C 96 Lbs.  
Std. Pkg. 10 Pcs.

**FITTING SPECIFICATIONS** (*unless noted*): Hole Size-9/16" Diameter; Hole Spacing-13/16" from end and 1 7/8" on center.  
Width-1 5/8"; Thickness 1/4"

**STANDARD FINISHES:** Zinc Plating

**ALSO AVAILABLE IN:** HDG and STAINLESS STEEL

**Four-Hole Corner Gusset**
**AF420**

Non-Stock Item  
Priced on Application

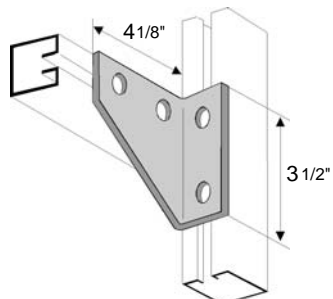

Wt./C 100 Lbs.  
Std. Pkg. 20 Pcs.

**Four-Hole Corner Gusset**
**AF421**

Non-Stock Item  
Priced on Application

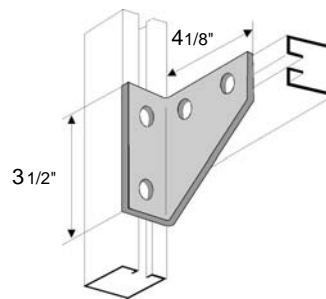

Wt./C 100 Lbs.  
Std. Pkg. 20 Pcs.

**Four-Hole Corner Gusset**
**AF422**

Non-Stock Item  
Priced on Application

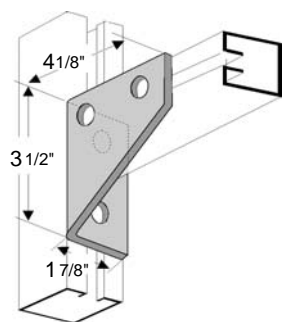

Wt./C 100 Lbs.  
Std. Pkg. 20 Pcs.

**Four-Hole Corner Gusset**
**AF423**

Non-Stock Item  
Priced on Application

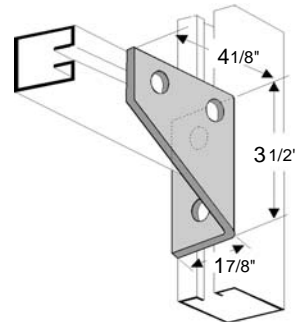

Wt./C 100 Lbs.  
Std. Pkg. 25 Pcs.

**Five-Hole Webbed  
Corner Angle**
**AF430**

Std Stocking Item

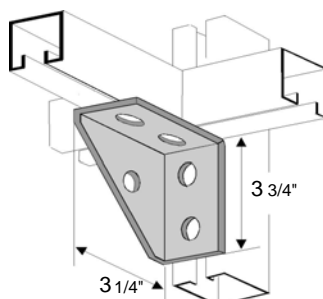

Wt./C 132 Lbs.  
Std. Pkg. 10 Pcs.

**Five-Hole Webbed  
Corner Angle**
**AF431**

Std Stocking Item

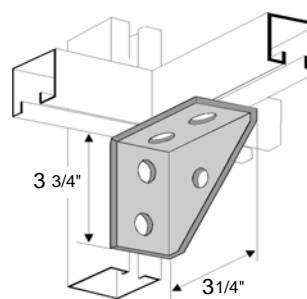

Wt./C 132 Lbs.  
Std. Pkg. 10 Pcs.

**FITTING SPECIFICATIONS** (unless noted) : Hole Size-9/16" Diameter; Hole Spacing-13/16" from end and 1 7/8" on center.  
Width-1 5/8"; Thickness 1/4"

**FINISHES AVAILABLE:** Zinc Plated, Hot-Dipped Galvanized & Stainless Steel

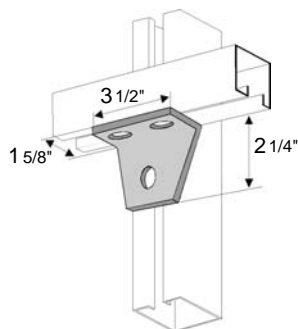
**Three Hole Shelf Gusset  
Angle**
**AF340**

Wt./C 67 Lbs.  
Std. Pkg. 20 Pcs.

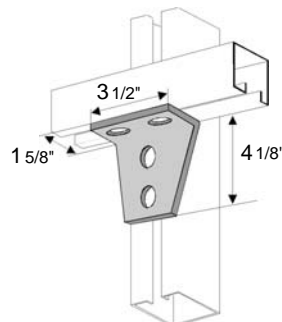
**Four Hole Shelf Gusset  
Angle**
**AF440**

Wt./C 102 Lbs.  
Std. Pkg. 20 Pcs.

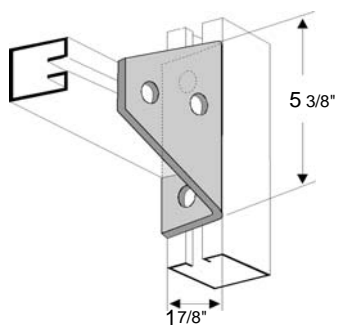
**Four Hole Shelf Gusset  
Angle**
**AF441**

Wt./C 148 Lbs.  
Std. Pkg. 20 Pcs.

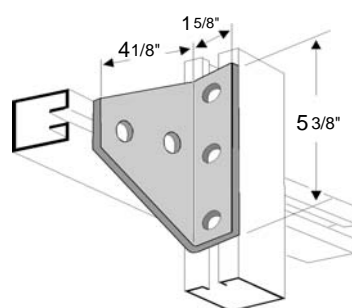
**Five Hole Shelf Gusset  
Angle**
**AF540**

Wt./C 141 Lbs.  
Std. Pkg. 20 Pcs.

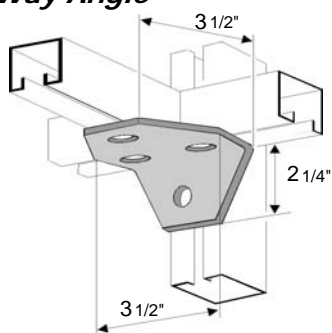
**Four Hole Shelf Gusset  
Three Way Angle**
**AF445**

Wt./C 101 Lbs.  
Std. Pkg. 20 Pcs.

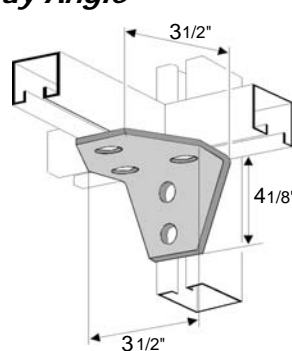
**Five Hole Shelf Gusset  
Three Way Angle**
**AF545**

Wt./C 135 Lbs.  
Std. Pkg. 15 Pcs.

**FITTING SPECIFICATIONS** (unless noted): Hole Size-9/16" Diameter; Hole Spacing-13/16" from end and 1 7/8" on center.  
Width-1 5/8"; Thickness 1/4"

**STANDARD FINISHES:** Zinc Plating

**ALSO AVAILABLE IN:** HDG and STAINLESS STEEL

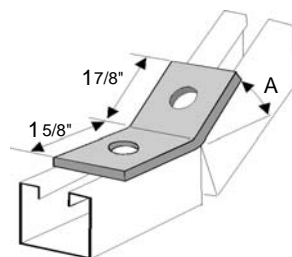
**Two Hole Open Short  
Angle**
**AF220**

PART No.	A
AF220-1	30°
AF220-2	45°
AF220-3	60°
AF220-4	75°

Wt./C 37 Lbs.  
Std. Pkg. 50 Pcs.

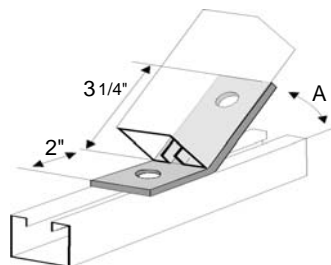
**Two Hole Open Angle**
**AF221**

PART No.	A
AF221-1	30°
AF221-2	45°
AF221-3	60°
AF221-4	75°

Wt./C 56 Lbs.  
Std. Pkg. 25 Pcs.

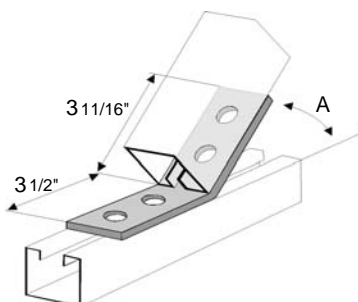
**Four Hole Open Angle**
**AF425**

PART No.	A
AF425-1	30°
AF425-2	45°
AF425-3	60°
AF425-4	75°

Wt./C 77 Lbs.  
Std. Pkg. 25 Pcs.

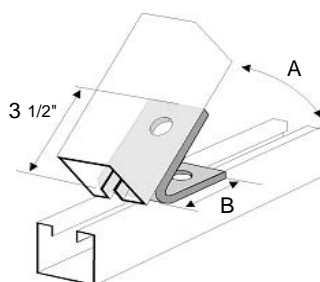
**Two Hole Closed Angle**
**AF225**

Std. Pkg. 25 Pcs.

PART No.	A	B	Wt. Per 100
AF225-1	30°	3 1/2	73 #
AF225-2	45°	2 1/2	62 #
AF225-3	60°	2 1/2	62 #
AF225-4	75°	2 1/2	62 #

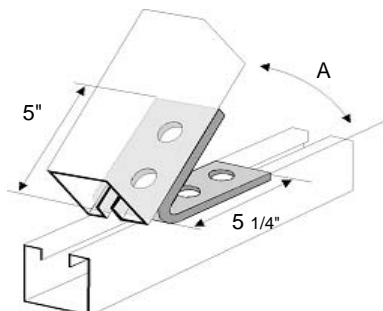
**Four Hole Closed Angle**
**AF426**

Wt./C 108 Lbs.  
Std. Pkg. 25 Pcs.

PART No.	A
AF426-1	30°
AF426-2	45°
AF426-3	60°
AF426-4	75°

**FITTING SPECIFICATIONS** (unless noted): Hole Size-9/16" Diameter; Hole Spacing-13/16" from end and 1 7/8" on center.  
Width-1 5/8"; Thickness 1/4"

**STANDARD FINISHES:** Zinc Plating

**ALSO AVAILABLE IN:** HDG and STAINLESS STEEL



**Post Base**
**PB100**

Non-Stock Item  
Priced on Application

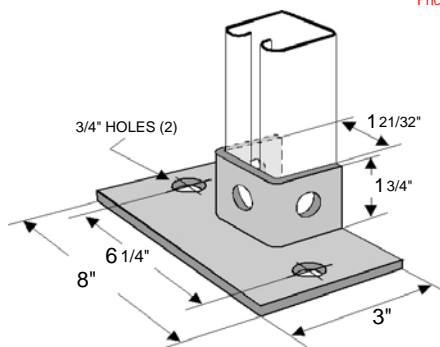

Wt./C 230 Lbs.  
Std. Pkg. 10 Pcs.

**Post Base**
**PB101**

Non-Stock Item  
Priced on Application

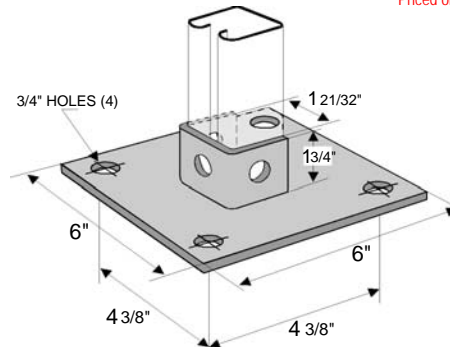

Wt./C 314 Lbs.  
Std. Pkg. 10 Pcs.

**Post Base**
**PB102**

Non-Stock Item  
Priced on Application

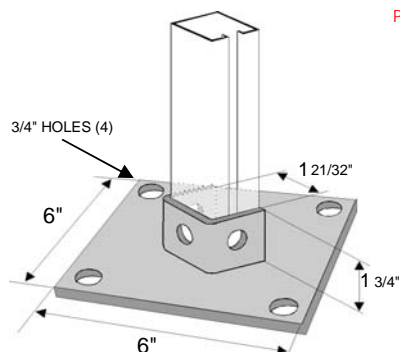

Wt./C 314 Lbs.  
Std. Pkg. 10 Pcs.

**Post Base**
**PB110**

Non-Stock Item  
Priced on Application

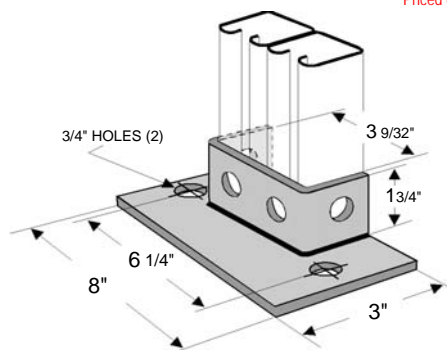

Wt./C 250 Lbs.  
Std. Pkg. 10 Pcs.

**Post Base**
**PB111**

Non-Stock Item  
Priced on Application

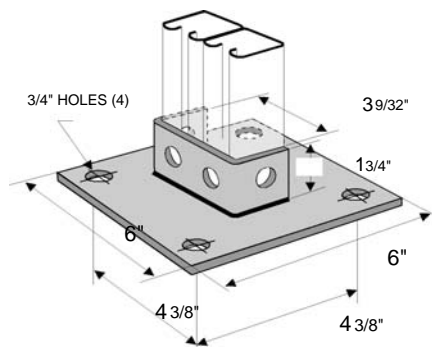

Wt./C 330 Lbs.  
Std. Pkg. 10 Pcs.

**Post Base**
**PB112**

Non-Stock Item  
Priced on Application

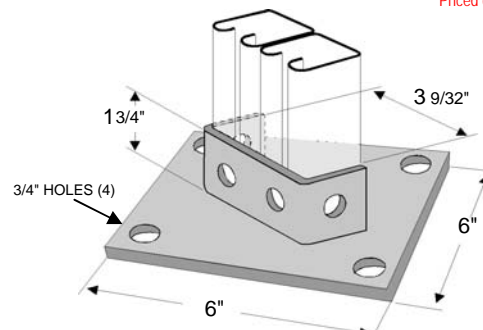

Wt./C 330 Lbs.  
Std. Pkg. 10 Pcs.

**FITTING SPECIFICATIONS** (*unless noted*) : Hole Size-9/16" Diameter; Hole Spacing-13/16" from end and 1 7/8" on center.  
Width-1 5/8"; Thickness 1/4"

**FINISHES AVAILABLE:** Zinc Plated, Hot-Dipped Galvanized & Stainless Steel

**Post Base**
**PB200**

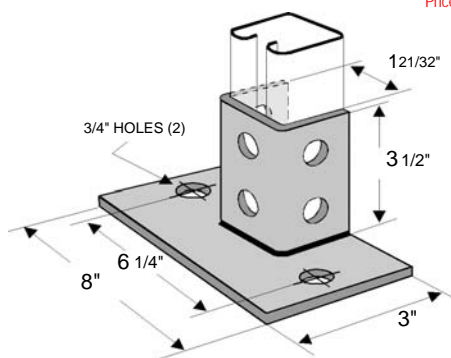
 Non-Stock Item  
Priced on Application

 Wt./C 312 Lbs.  
Std. Pkg. 5 Pcs.

**Post Base**
**PB201**

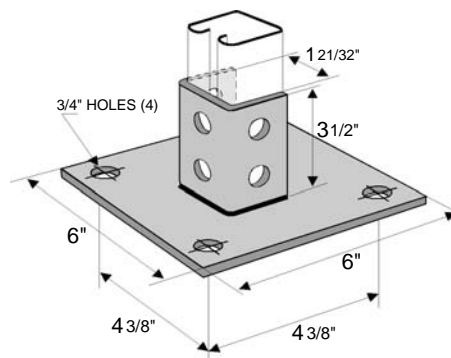
Std Stocking Item



 Wt./C 392 Lbs.  
Std. Pkg. 5 Pcs.

**Post Base**
**PB202**

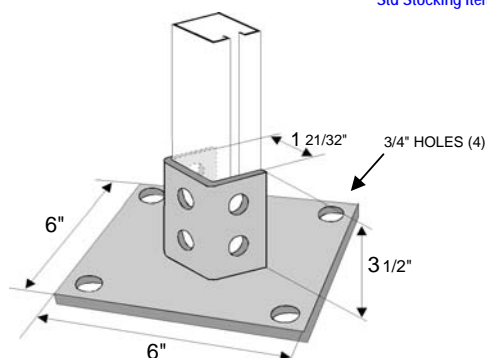
Std Stocking Item

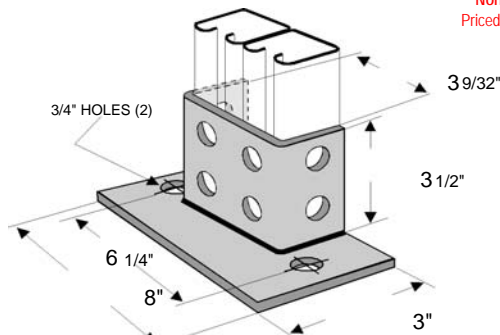

 Wt./C 392 Lbs.  
Std. Pkg. 5 Pcs.

**Post Base**
**PB210**

 Non-Stock Item  
Priced on Application

 Wt./C 320 Lbs.  
Std. Pkg. 5 Pcs.

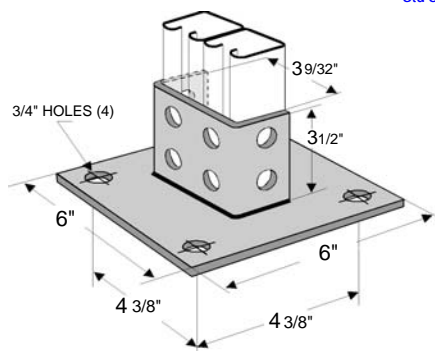
**Post Base**
**PB211**

Std Stocking Item

 Wt./C 400 Lbs.  
Std. Pkg. 5 Pcs.

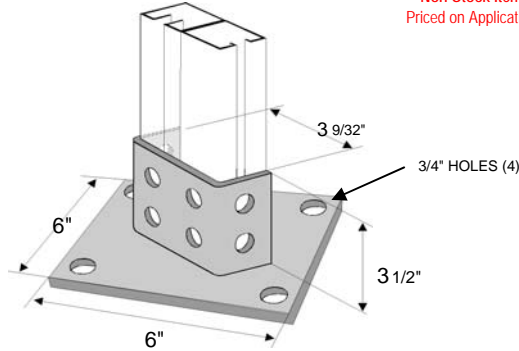
**Post Base**
**PB212**

 Non-Stock Item  
Priced on Application

 Wt./C 400 Lbs.  
Std. Pkg. 5 Pcs.

**FITTING SPECIFICATIONS** (unless noted) : Hole Size-9/16" Diameter; Hole Spacing-13/16" from end and 1 7/8" on center.  
Width-1 5/8"; Thickness 1/4"

**FINISHES AVAILABLE:** Zinc Plated, Hot-Dipped Galvanized & Stainless Steel

**Two-Hole Splice Plate****UF200**

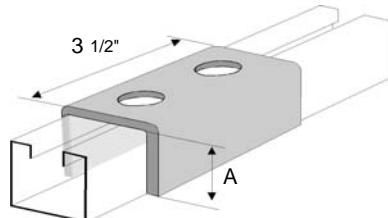
Non-Stock Item  
Priced on Application



PART No.	A	Wt. Per 100	Std. Pkg.
UF200-1	13/16"	84 #	25
UF200-2	1"	91 #	25
UF200-3	1 3/8"	110 #	25
UF200-4	1 5/8"	121 #	25
UF200-5	2"	141 #	20
UF200-6	2 7/16"	162 #	20
UF200-7	3 1/4"	202 #	20

**Three-Hole Splice Plate****UF300**

Non-Stock Item  
Priced on Application

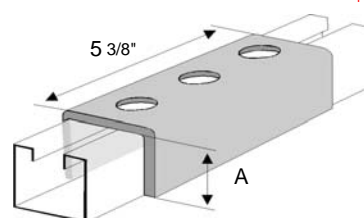

PART No.	A	Wt. Per 100	Std. Pkg.
UF300-1	13/16"	126 #	25
UF300-2	1"	140 #	25
UF300-3	1 3/8"	169 #	25
UF300-4	1 5/8"	186 #	25
UF300-5	2"	217 #	20
UF300-6	2 7/16"	250 #	20
UF300-7	3 1/4"	312 #	20

**Four-Hole "U" Splice****UF400**

Stocking Item  
(UF400-4)

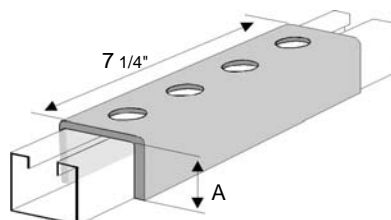

PART No.	A	Wt. Per 100	Std. Pkg.
UF400-1	13/16"	170 #	15
UF400-2	1"	189 #	15
UF400-3	1 3/8"	228 #	15
UF400-4	1 5/8"	250 #	15
UF400-5	2"	292 #	10
UF400-6	2 7/16"	337 #	10
UF400-7	3 1/4"	420 #	10

**Three-Hole "U" Support****UF310**

Stocking Item  
(UF310-4 with 5 holes)

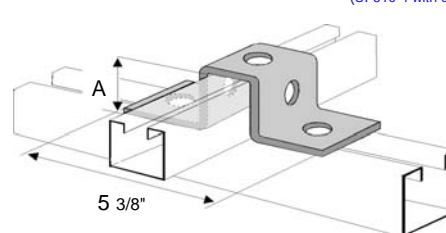

PART No.	A	Wt. Per 100
UF310-2	1"	75 #
UF310-3	1 3/8"	84 #
UF310-4	1 5/8"	90 #
UF310-5	2"	99 #
UF310-6	2 7/16"	108 #
UF310-7	3 1/4"	126 #

Std. Pkg. 25 Pcs.

**Three-Hole Offset "U" Support****UF315**

Non-Stock Item  
Priced on Application

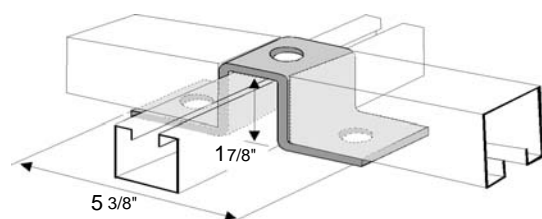

Wt./C 89 Lbs.  
Std. Pkg. 25 Pcs.

**Five-Hole "U" Support****UF500**

Non-Stock Item  
Priced on Application

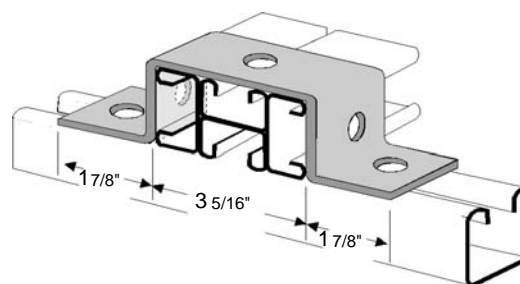

Wt./C 106 Lbs.  
Std. Pkg. 10 Pcs.

**FITTING SPECIFICATIONS** (unless noted): Hole Size-9/16" Diameter; Hole Spacing-13/16" from end and 1 7/8" on center.  
Width-1 1/2"; Thickness 1/4"

**FINISHES AVAILABLE:** Zinc Plated, Hot-Dipped Galvanized & Stainless Steel

**Six-Hole "U" Support**
**UF600**

Non-Stock Item  
Priced on Application

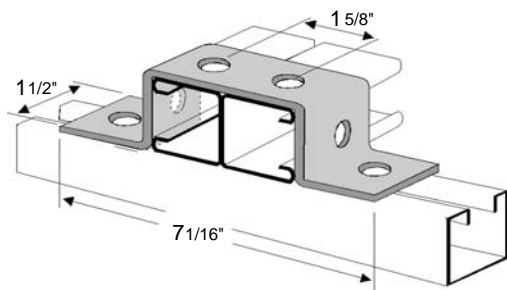

Wt./C 105 Lbs.  
Std. Pkg. 10 Pcs.

**Two-Hole Clevis**
**UF210**

Non-Stock Item  
Priced on Application

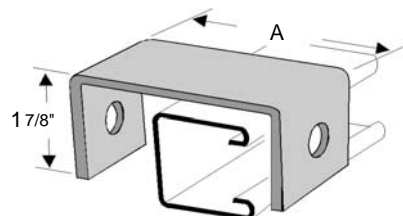

Std. Pkg. 20 Pcs.

PART No.	A	Wt. Per 100
UF210-1	4"	89 #
UF210-2	5"	93 #
UF210-3	6"	106 #
UF210-4	7"	118 #
UF210-5	8"	132 #

**Four-Hole Clevis**
**UF410**

Non-Stock Item  
Priced on Application

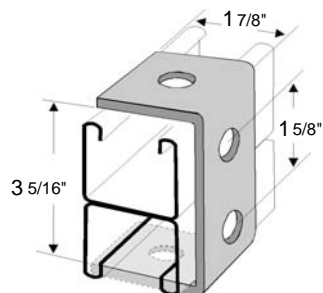

Wt./C 71 Lbs.  
Std. Pkg. 20 Pcs.

**Three-Hole Suspension  
Clevis**
**UF330**

Non-Stock Item  
Priced on Application

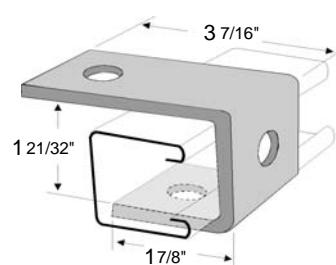

Wt./C 75 Lbs.  
Std. Pkg. 20 Pcs.

**Three-Hole Cup Support**
**UF331**

Non-Stock Item  
Priced on Application

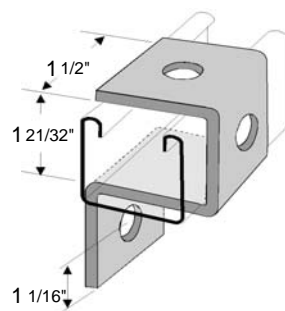

Wt./C 73 Lbs.  
Std. Pkg. 20 Pcs.

**FITTING SPECIFICATIONS** (*unless noted*): Hole Size-9/16" Diameter; Hole Spacing-13/16" from end and 1 7/8" on center.  
Width-1 1/2"; Thickness 1/4"

**FINISHES AVAILABLE:** Zinc Plated, Hot-Dipped Galvanized & Stainless Steel

**Three-Hole Single  
Wing Connection**
**WF300**

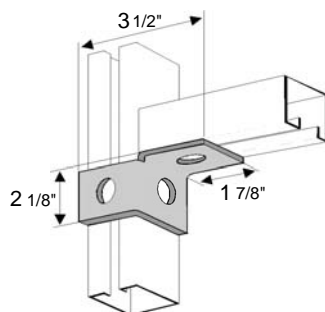
 Non-Stock Item  
Priced on Application

 Wt./C 54 Lbs.  
Std. Pkg. 20 Pcs.

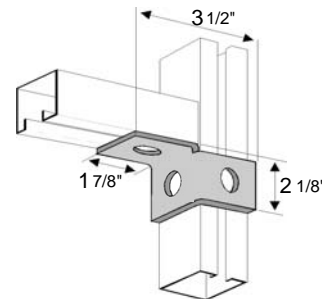
**Three-Hole Single  
Wing Connection**
**WF301**

 Non-Stock Item  
Priced on Application

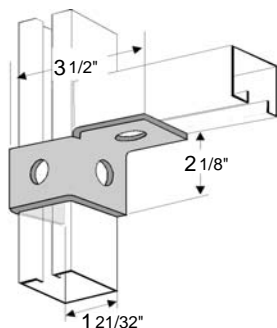
 Wt./C 54 Lbs.  
Std. Pkg. 20 Pcs.

**Four-Hole Single  
Wing Connection**
**WF400**

 Non-Stock Item  
Priced on Application

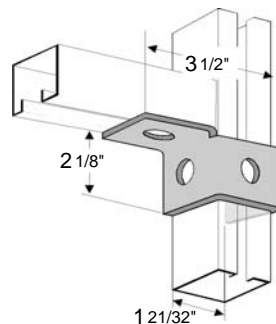
 Wt./C 77 Lbs.  
Std. Pkg. 10 Pcs.

**Four-Hole Single  
Wing Connection**
**WF401**

 Non-Stock Item  
Priced on Application

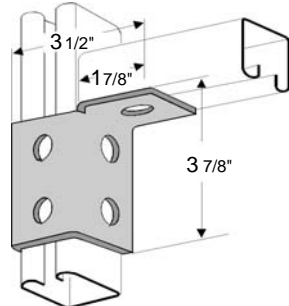
 Wt./C 77 Lbs.  
Std. Pkg. 10 Pcs.

**Five-Hole Single  
Wing Connection**
**WF500**

 Non-Stock Item  
Priced on Application

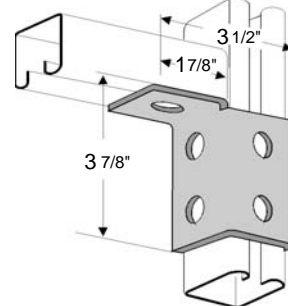
 Wt./C 100 Lbs.  
Std. Pkg. 20 Pcs.

**Five-Hole Single  
Wing Connection**
**WF501**

 Non-Stock Item  
Priced on Application

 Wt./C 100 Lbs.  
Std. Pkg. 20 Pcs.

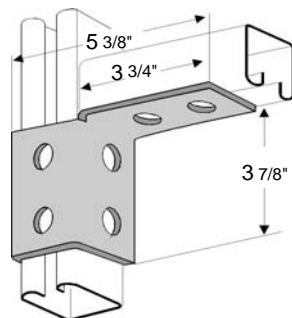
**FITTING SPECIFICATIONS** (unless noted) : Hole Size-9/16" Diameter; Hole Spacing-13/16" from end and 1 7/8" on center.  
Width-1 5/8"; Thickness 1/4"

**FINISHES AVAILABLE:** Zinc Plated, Hot-Dipped Galvanized & Stainless Steel

**Six Hole Single  
Corner Connection**
**WF600**

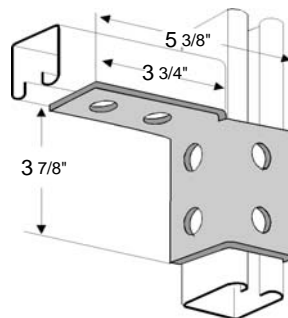
Wt./C 120 Lbs.  
Std. Pkg. 20 Pcs.

**Six Hole Single  
Corner Connection**
**WF601**

Wt./C 120 Lbs.  
Std. Pkg. 20 Pcs.

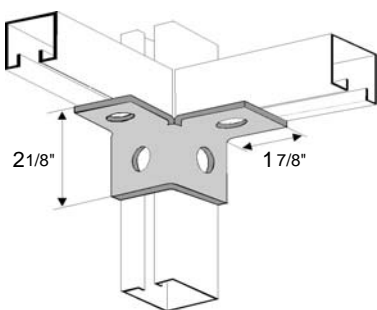
**Four Hole Double  
Corner Connection**
**WF405**

Wt./C 71 Lbs.  
Std. Pkg. 20 Pcs.

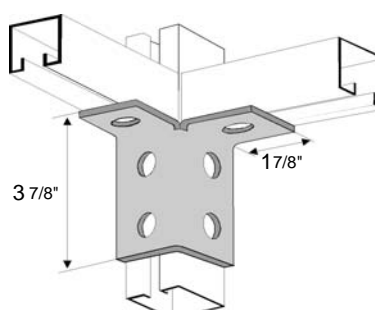
**Six Hole Double  
Corner Connection**
**WF605**

Wt./C 110 Lbs.  
Std. Pkg. 20 Pcs.

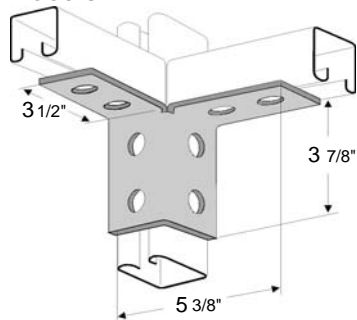
**Eight Hole Double  
Corner Connection**
**WF805**

Wt./C 152 Lbs.  
Std. Pkg. 10 Pcs.

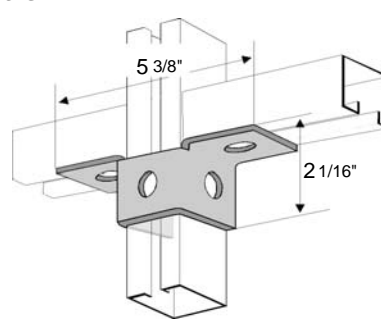
**Five Hole Double Wing  
Connection**
**WF510**

Wt./C 95 Lbs.  
Std. Pkg. 10 Pcs.

**FITTING SPECIFICATIONS** (unless noted): Hole Size-9/16" Diameter; Hole Spacing-13/16" from end and 1 7/8" on center.  
Width-1 5/8"; Thickness 1/4"

**STANDARD FINISHES:** Zinc Plated

**ALSO AVAILABLE IN:** HDG and STAINLESS STEEL

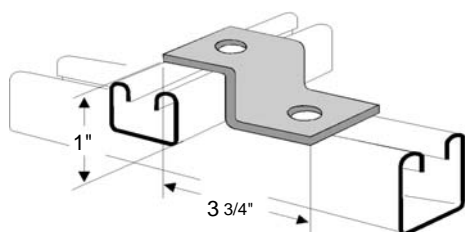

**Two-Hole "Z" Support**
**ZF201**

 Non-Stock Item  
Priced on Application

 Wt./C 44 Lbs.  
Std. Pkg. 25 Pcs.

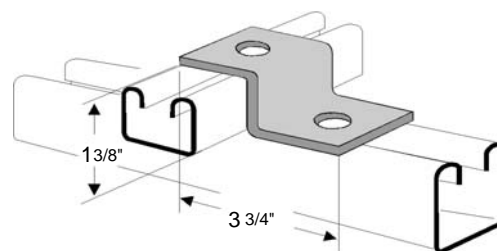
**Two-Hole "Z" Support**
**ZF202**

 Non-Stock Item  
Priced on Application

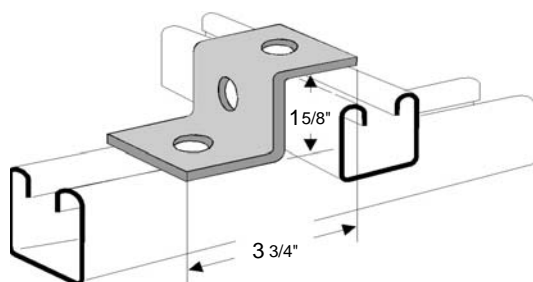
 Wt./C 51 Lbs.  
Std. Pkg. 25 Pcs.

**Three-Hole "Z" Support**
**ZF203**

 Non-Stock Item  
Priced on Application

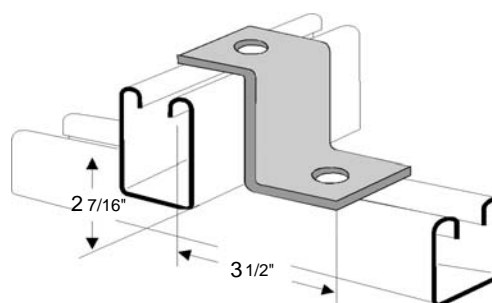
 Wt./C 51 Lbs.  
Std. Pkg. 25 Pcs.

**Two-Hole "Z" Support**
**ZF204**

 Non-Stock Item  
Priced on Application

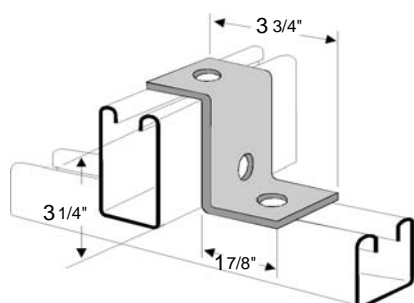
 Wt./C 63 Lbs.  
Std. Pkg. 25 Pcs.

**Three-Hole "Z" Support**
**ZF205**

 Non-Stock Item  
Priced on Application

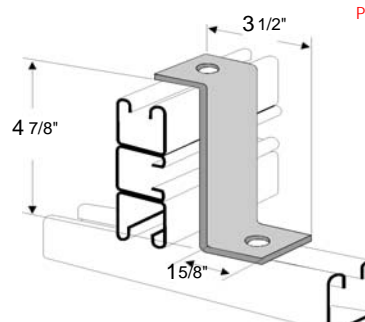
 Wt./C 70 Lbs.  
Std. Pkg. 25 Pcs.

**Two-Hole "Z" Support**
**ZF206**

 Non-Stock Item  
Priced on Application

 Wt./C 90 Lbs.  
Std. Pkg. 25 Pcs.

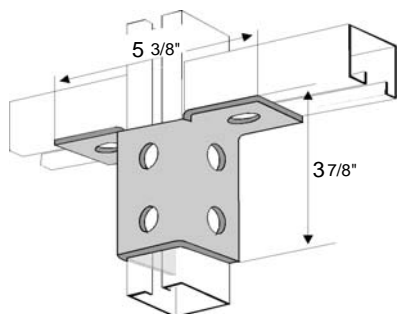
**FITTING SPECIFICATIONS** (unless noted): Hole Size-9/16" Diameter; Hole Spacing-13/16" from end and 1 7/8" on center.  
Width-1 1/2"; Thickness 1/4"

**FINISHES AVAILABLE:** Zinc Plated, Hot-Dipped Galvanized & Stainless Steel

**Eight Hole Double Wing  
Connection**
**WF810**

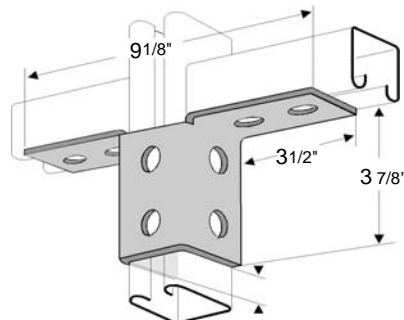
Wt./C 156 Lbs.  
Std. Pkg. 20 Pcs.

**Ten Hole Double Wing  
Connection**
**WF1010**

Wt./C 185 Lbs.  
Std. Pkg. 10 Pcs.

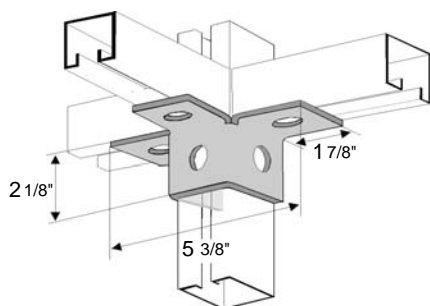
**Six Hole Triple Wing  
Connection**
**WF620**

Wt./C 110 Lbs.  
Std. Pkg. 20 Pcs.

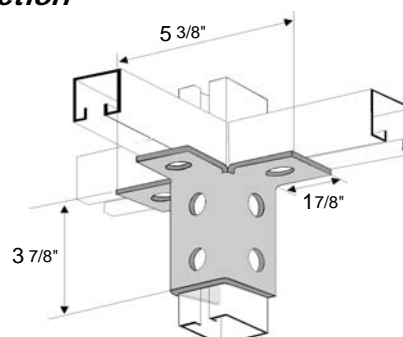
**Nine Hole Triple Wing  
Connection**
**WF920**

Wt./C 177 Lbs.  
Std. Pkg. 10 Pcs.

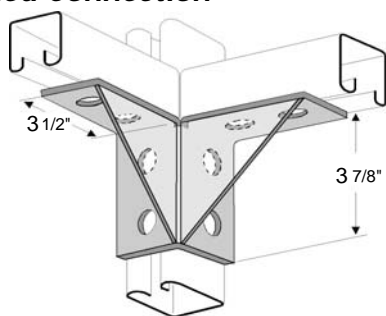
**Eight Hole Double Corner  
Gusseted Connection**
**WF830**

Wt./C 196 Lbs.  
Std. Pkg. 5 Pcs.

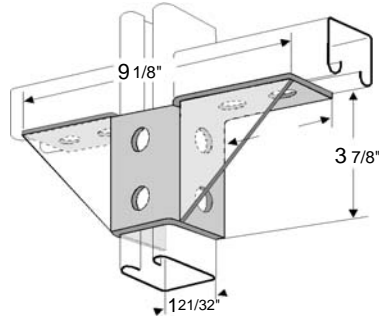
**Ten Hole Double Wing  
Gusseted Connection**
**WF1030**

Wt./C 240 Lbs.  
Std. Pkg. 5 Pcs.

**FITTING SPECIFICATIONS** (unless noted): Hole Size-9/16" Diameter; Hole Spacing-13/16" from end and 1 7/8" on center.  
Width-1 5/8"; Thickness 1/4"

**STANDARD FINISHES:** Zinc Plated

**ALSO AVAILABLE IN:** HDG and STAINLESS STEEL

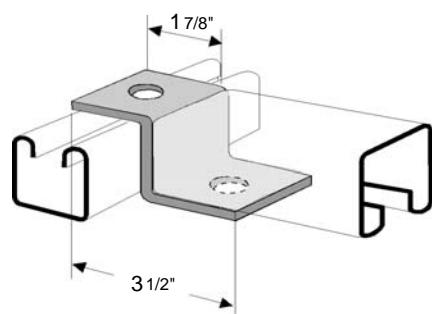
**Two Hole Offset  
"Z" Support**
**ZF210**

Wt./C 55 Lbs.  
Std. Pkg. 25 Pcs.

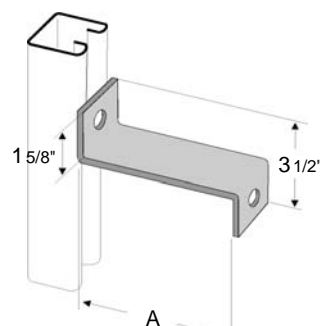
**Two Hole "Z" Bus Duct  
Connection**
**ZF220**

PART No.	A	Wt. Per 100	Std. Pkg.
ZF220-1	2 5/32"	62 #	25
ZF220-2	3 17/32"	78 #	20
ZF220-3	4 1/2"	89 #	20

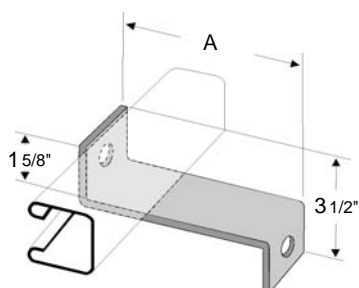
**Two Hole "Z" Support**
**ZF221**

PART No.	A	Wt. Per 100
ZF221-1	4"	77 #
ZF221-2	5"	95 #
ZF221-3	6"	98 #
ZF221-4	7"	105 #
ZF221-5	8"	120 #

Std. Pkg. 20 Pcs.

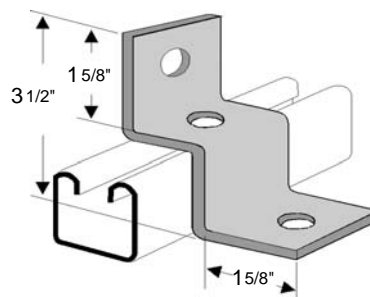
**Three Hole Sheath  
Corner Connection**
**ZF300**

Wt./C 68 Lbs.  
Std. Pkg. 20 Pcs.

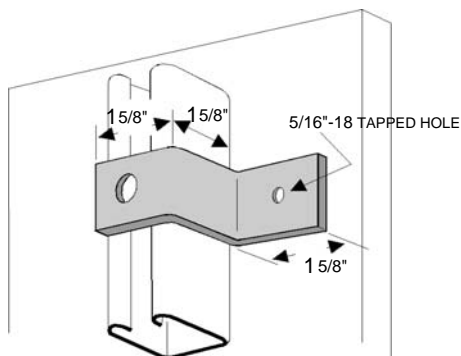
**Tapped "Z" Support**
**ZF230**

Wt./C 51 Lbs.  
Std. Pkg. 25 Pcs.

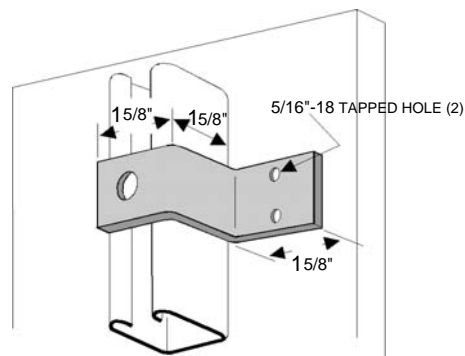
**Tapped "Z" Support**
**ZF231**

Wt./C 50 Lbs.  
Std. Pkg. 25 Pcs.

**FITTING SPECIFICATIONS** (unless noted): Hole Size-9/16" Diameter; Hole Spacing-13/16" from end and 1 7/8" on center.  
Width-1 1/2"; Thickness 1/4"

**STANDARD FINISHES:** Zinc Plating

**ALSO AVAILABLE IN:** HDG and STAINLESS STEEL

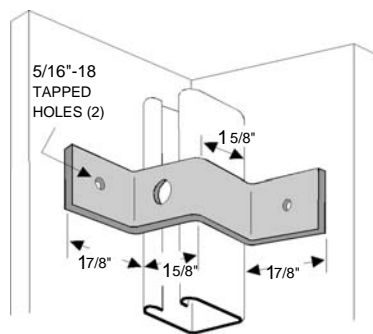
**Tapped Corner  
Connection**
**ZF330**

Wt./C 71 Lbs.  
Std. Pkg. 20 Pcs.

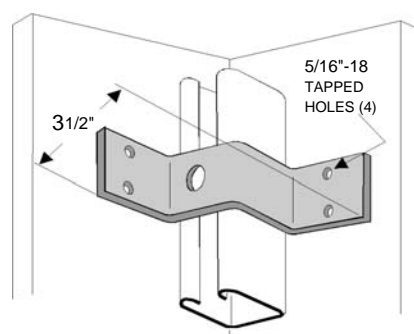
**Tapped Corner  
Connection**
**ZF331**

Wt./C 68 Lbs.  
Std. Pkg. 20 Pcs.

**FITTING SPECIFICATIONS** (*unless noted*): Hole Size-9/16" Diameter; Hole Spacing-13/16" from end and 1 7/8" on center.  
Width-1 1/2"; Thickness 1/4"

**STANDARD FINISHES:** Zinc Plating

**ALSO AVAILABLE IN:** HDG and STAINLESS STEEL

**Beam Clamp**
**BC460**

Non-Stock Item  
Priced on Application

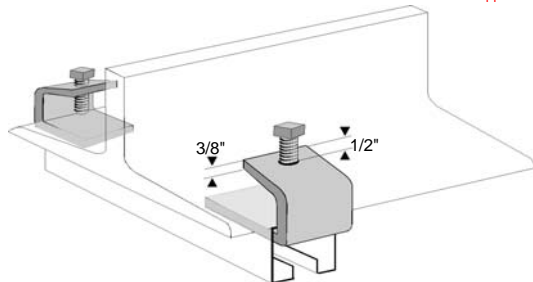

Maximum flange thickness 1"  
Design Load 1000 Lbs. (12Ga. Strut)  
when used in pairs.

1/2"-13 Setscrew included.  
3/8"x 1 1/4" Material

**Wt./C 62 Lbs.**  
**Std. Pkg. 25 Pcs.**

Sold in pieces

**Beam Clamp**
**BC470**

Stocking Item

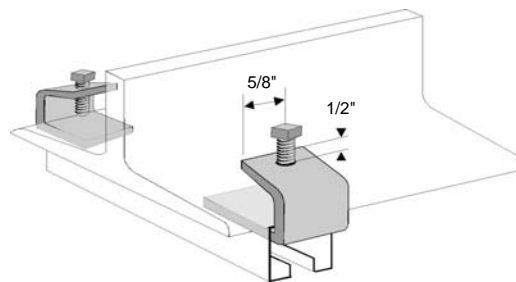

Maximum flange thickness 3/4"  
Design Load 600 Lbs. (12Ga. Strut)  
when used in pairs.

3/8" - 16 Setscrew included.  
1/4" x 1 1/4" Material

**Wt./C 40 Lbs.**  
**Std. Pkg. 50 Pcs.**

Sold in pieces

**Beam Clamp**
**BC480**

Stocking Item

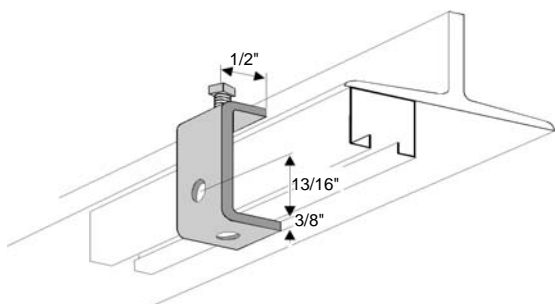

Design Load 800 Lbs. (12Ga. Strut)  
when used in pairs.

1/2"-13 Setscrew included.  
3/8" x 1 1/2" Material

**Wt./C 95 Lbs.**  
**Std. Pkg. 25 Pcs.**

Sold in pieces

**"Z" Beam Clamp**
**BC490**

Non-Stock Item  
Priced on Application

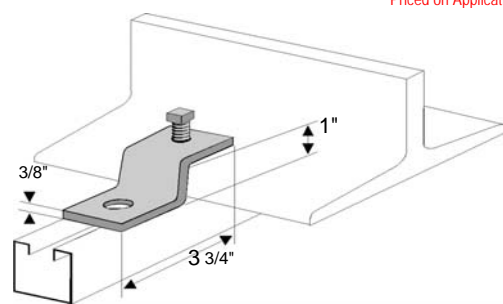

Design Load 600 Lbs. (12Ga. Strut)  
when used in pairs.

1/2"-13 Setscrew included.  
3/8" x 1 1/2" Material

**Wt./C 70 Lbs.**  
**Std. Pkg. 25 Pcs.**

Sold in pieces

**"Z" Beam Clamp**
**BC491**

Stocking Item

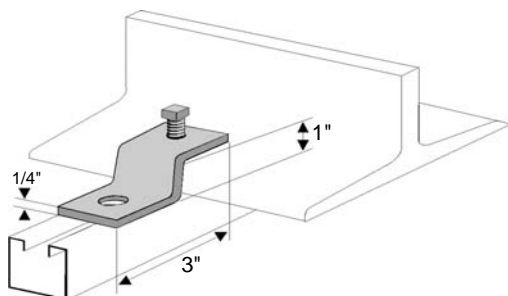

Design Load 500 Lbs. (12Ga. Strut)  
when used in pairs.

1/2"-13 Setscrew included.  
1/4" x 1 3/4" Material

**Wt./C 44 Lbs.**  
**Std. Pkg. 25 Pcs.**

Sold in pieces

**Window Beam Clamp**
**BC500**

Stocking Item

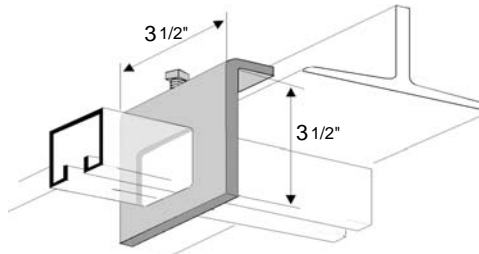

For use with 1 5/8" channel height  
Design Load 800 Lbs. (12Ga. Strut)  
when used in pairs.

1/2"-13 Setscrew included.

**Wt./C 112 Lbs.**  
**Std. Pkg. 25 Pcs.**

Sold in pieces

**FITTING SPECIFICATIONS** (unless noted): Hole Size-9/16" Diameter; Hole Spacing-13/16" from end and 1 7/8" on center.  
Width-1 5/8"; Thickness 1/4"

**FINISHES AVAILABLE:** Zinc Plated, Hot-Dipped Galvanized & Stainless Steel

### Beam Clamp

### BC515

Std Stocking Item

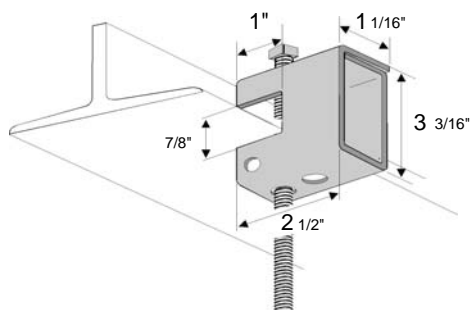

Maximum flange thickness 13/16"  
Design Load 750 Lbs. (12Ga. Strut)  
Wrapped seam welded.  
1/2"-13 Setscrew and Square  
Nut included.

1/8" Material

Wt./C 80 Lbs.  
Std. Pkg. 25 Pcs.

### Beam Clamp & Swing Connector Assembly

### BC516A

Non-Stock Item  
Priced on Application

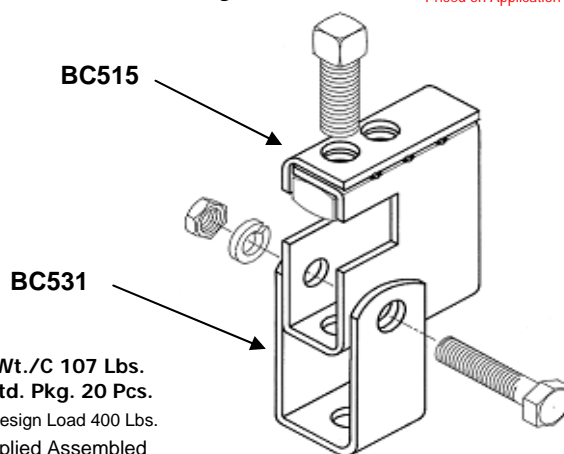

Wt./C 107 Lbs.  
Std. Pkg. 20 Pcs.  
Design Load 400 Lbs.  
Supplied Assembled

### Beam Clamp Safety Strap

### BC520

Non-Stock Item  
Priced on Application

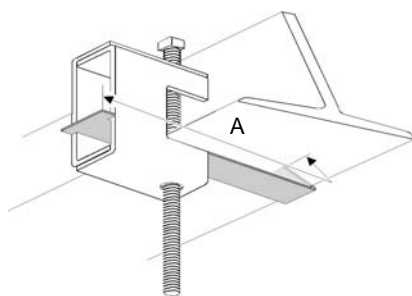

SIZE	A
BC520-6	8"
BC520-6A	9"
BC520-9	11"
BC520-9A	12"
BC520-12A	15"
BC520-16	20"
BC520-20	23"

Std. Pkg. BULK

14 Ga. X 1 1/4" Pre-Galvanized Material

### Beam Clamp Swing Connector

### BC531

Non-Stock Item  
Priced on Application

Allows for angular adjustment when using BC510 and BC512 beam clamps.

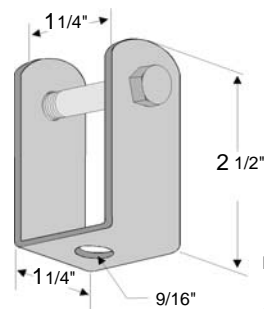

Design Load 400 Lbs.

1/8" Material

3/8"-16 Capscrew, Lockwasher,  
and Nut included.

Wt./C 27 Lbs.  
Std. Pkg. 25 Pcs.

### Beam Clamp

### BC540

Non-Stock Item  
Priced on Application

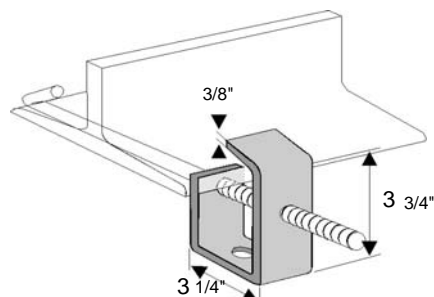

PART No.	Bolt Length	For Flange Width	Wt. Per 100
BC540-1	11"	4" - 9"	240#
BC540-2	19 1/2"	10" - 17"	300#

Maximum Load 800#

Std. Pkg. BULK

Includes: 1 pc. Beam Clamp  
1 pc. J Hook  
2 pc 1/2"-13 Hex Nuts

### Beam Clamp-Single Strut

### BC890

Std Stocking Item

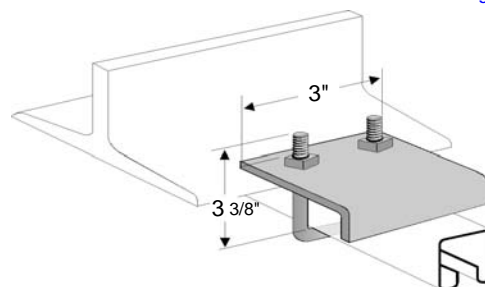

For use with 13/16" to 1 5/8" high channel

Sold in Pieces

Design Load 1200 Lbs. (12Ga. Strut)  
when used in pairs.

3/8"-16 Square "U" Bolt  
and Nuts included.

Recommended Torque:  
150 in-lbs. (16.9 N\*m)

Wt./C 83 Lbs.  
Std. Pkg. 25 Pcs.

**FITTING SPECIFICATIONS** (unless noted): Hole Size-9/16" Diameter; Hole Spacing-13/16" from end and 1 7/8" on center.  
Width-1 5/8"; Thickness 1/4"

**FINISHES AVAILABLE:** Zinc Plated, Hot-Dipped Galvanized & Stainless Steel



**Beam Clamp-Double Strut**
**BC891**

Std Stocking Item

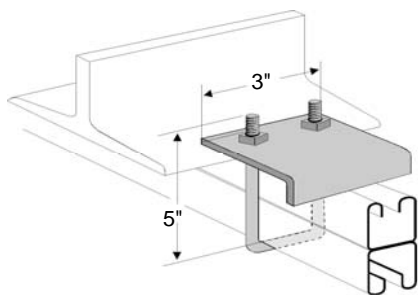

3/8"-16 Square "U" Bolt and Nuts included  
For use with 1 5/8" to 3 1/4" high channel  
Design Load 1200 Lbs. (12Ga. Strut) when used in pairs  
Recommended Torque:

150 in.-lbs. (16.9 N\*m)

Sold in Pieces

Wt./C 92 Lbs.  
Std. Pkg. 25 Pcs.

**Beam Clamp**
**BC900**

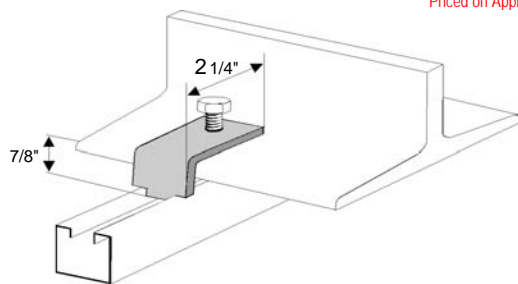
 Non-Stock Item  
Priced on Application

Design Load 1000 Lbs. (12Ga. Strut)  
when used in pairs.

Sold in pieces

Wt./C 26 Lbs.  
Std. Pkg. 50 Pcs.

**Beam Clamp**
**BC700**

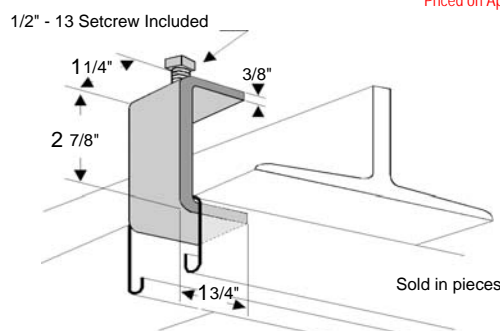
 Non-Stock Item  
Priced on Application

Design Load 1000 Lbs. (12Ga. Strut)  
when used in pairs.

Wt./C 80 Lbs.  
Std. Pkg. 25 Pcs.

**FITTING SPECIFICATIONS** (unless noted) : Hole Size-9/16" Diameter; Hole Spacing-13/16" from end and 1 7/8" on center.  
Width-1 5/8"; Thickness 1/4"

**FINISHES AVAILABLE:** Zinc Plated, Hot-Dipped Galvanized & Stainless Steel



# #BC954 Beam Clamp

# #BC955 Beam Clamp

**Finishes** Zinc Plated

**Materials** Carbon Steel

**Recommended** Used to create a support point inside the channel of an I-beam

**Notes** Strut channel (not included) needs to be cut 1" less than the flange opening to complete the clamp assembly.

Once assembled secure the clamp in place by tightening the four set screws

For ordering, one clamp consists of two side plates and four set screws.

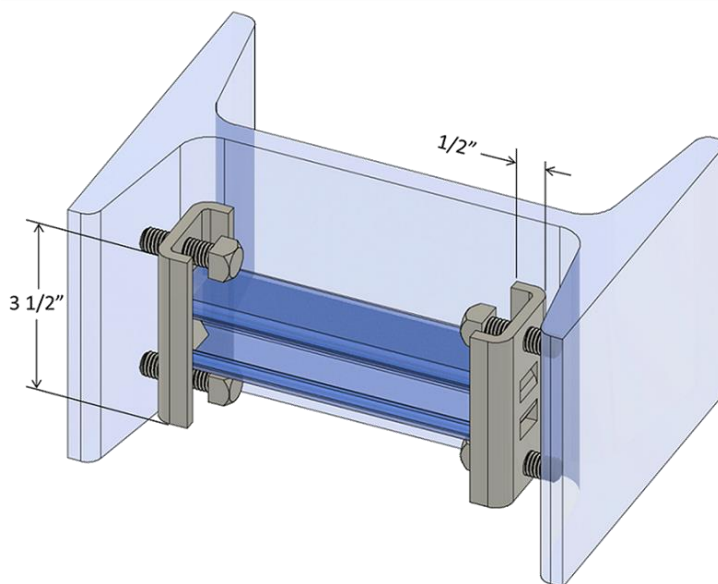

Part Number	When Used with Channel Size	SPECIFICATION DATA			
		Pull Out Resistance		Slip Resistance	
		Lbs	Kg	Lbs	Kg
BC954	1 5/8" - 12ga	1000	454	800	363
BC954	1 5/8" - 16ga	500	227	300	136
BC954	1 5/8" - 14ga	700	318	500	227
BC955	1" - 12ga	1000	454	800	363

QWI 4.3.1 Issue Date Apr/19 Rev.1

Note: when referencing a printed copy of this specification page, please insure it is the latest version as found on our website at [www.taylorpipesupports.ca](http://www.taylorpipesupports.ca)

For more information, please contact Customer Service at 1-800-263-8652

**Two-Hole 45° Knee Brace**
**MF100**

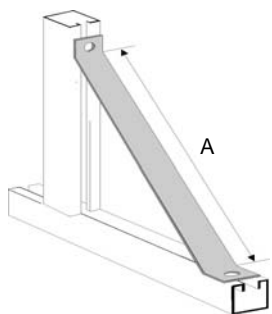
 Non Stock Item  
Priced on Application

Std. Pkg. BULK

PART No.	Dim. A	Wt. Per 100
MF100-1	8 1/2"	125 #
MF100-2	12"	162 #
MF100-3	17"	216 #
MF100-4	25"	300 #
MF100-5	36"	418 #

**Wall Ladder Bracket**
**MF110**

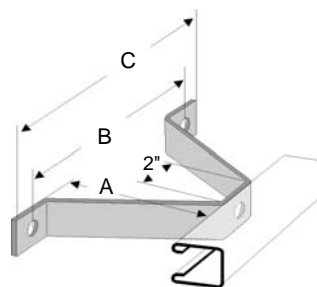
 Non Stock Item  
Priced on Application

Std. Pkg. BULK

PART No.	Dim. A	Dim. B	Dim. C	Wt. Per 100
MF110-1	2 3/8"	6"	7 1/2"	110 #
MF110-2	4 3/8"	8"	9 1/2"	164 #
MF110-3	6 3/8"	10"	11 1/2"	200 #
MF110-4	8 3/8"	12"	13 1/2"	253 #
MF110-5	10 3/8"	14"	15 1/2"	318 #

**Series Ladder Rungs**
**MF120**

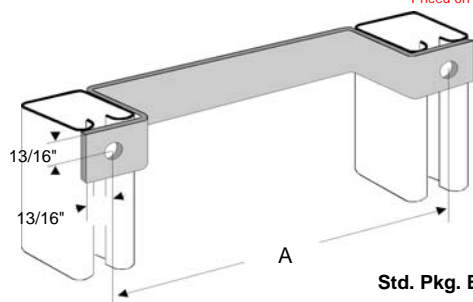
 Non Stock Item  
Priced on Application

Std. Pkg. BULK

PART No.	Dim. A	Wt. Per 100
MF120-1	12"	176 #
MF120-2	15"	202 #
MF120-3	18"	234 #

**Pipe Support Bracket**
**MF130**  
**MF131**

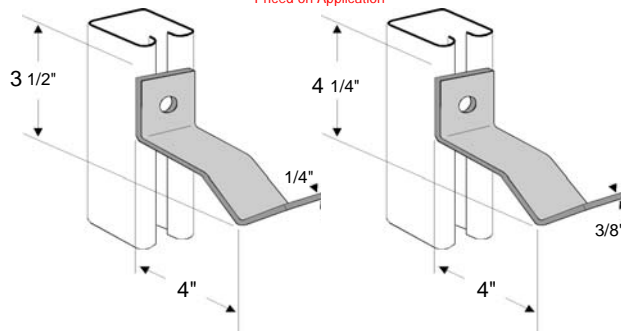
 Non Stock Item  
Priced on Application

**MF130**  
Wt./C 88 Lbs.  
Std. Pkg. 20 Pcs.

**MF131**  
Wt./C 132 Lbs.  
Std. Pkg. 20 Pcs.

**Single Channel Bracket**
**SB120**

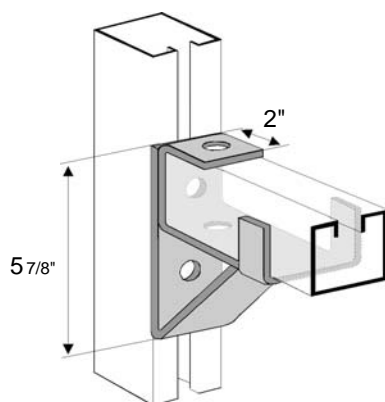
Std Stocking Item

 Wt./C 250 Lbs.  
Std. Pkg. 5 Pcs.

**Double Channel Bracket**
**SB121**

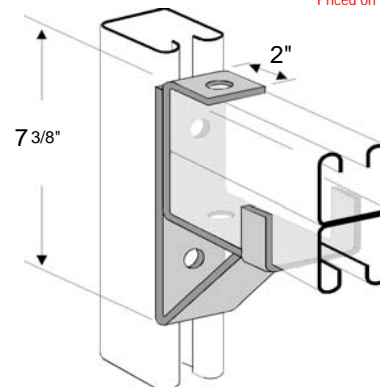
 Non Stock Item  
Priced on Application

 Wt./C 284 Lbs.  
Std. Pkg. BULK

**FITTING SPECIFICATIONS** (unless noted): Hole Size-9/16" Diameter; Hole Spacing-13/16" from end and 1 7/8" on center.  
Width-1 1/2"; Thickness 1/4"

**FINISHES AVAILABLE:** Zinc Plated, Hot-Dipped Galvanized & Stainless Steel

### Channel Plate Bracket Only

### SB125

Non-Stock Item  
Priced on Application

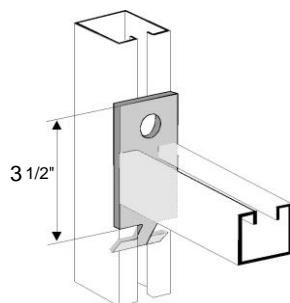

Finish: BARE METAL

Wt./C 45 Lbs.  
Std. Pkg. BULK

### Single Channel Bracket

### SB130

S = Stocking Item  
Other Sizes Available

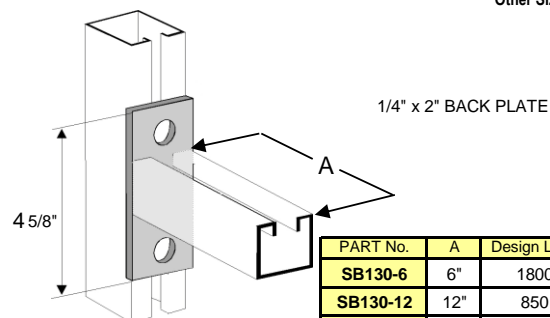

PART No.	A	Design Load	WT. Per 100
SB130-6	6"	1800	152 #
SB130-12	12"	850	232 #
SB130-18	18"	600	312 #
SB130-24	24"	400	450 #

Design Load Safety Factor 2.5

### Single Channel Bracket

### SB140

Non-Stock Item  
Priced on Application

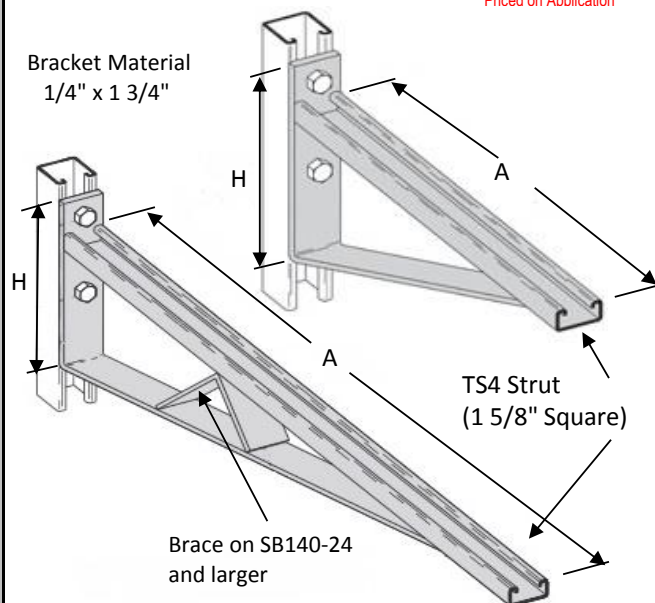

PART No.	A	H	Uniform Load
SB140-12	12"	8 3/4"	1500
SB140-15	15"	8 3/4"	1000
SB140-21	21"	8 3/4"	1000
SB140-24	24"	8 3/4"	900
SB140-27	27"	8 3/4"	900
SB140-33	33"	11 1/4"	800
SB140-39	39"	11 1/4"	600

**FITTING SPECIFICATIONS** (unless noted): Hole Size-9/16" Diameter; Hole Spacing-13/16" from end and 1 7/8" on center.  
Width-1 5/8"; Thickness 1/4"

**FINISHES AVAILABLE:** Zinc Plating, Hot-Dipped Galvanized & Stainless Steel