

**Finishes** Bare Metal, Zinc Plated (#E31Z)

**Materials** Carbon Steel, Stainless Steel 304SS & 316SS

**Approvals** Complies with MSS SP-58 & SP-69 (Type 10)

**Recommended** for the suspension of non-insulated stationary pipe lines allowing for vertical adjustment. Secure with hex nuts (not supplied) tightened securely top and bottom.

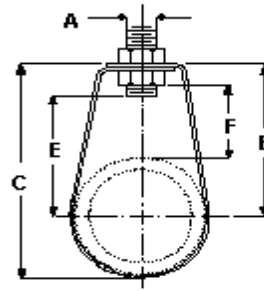

IRON PIPE SIZE	SPECIFICATION DATA					REC. MAX LOAD (LBS)	APP'X WT. PER 100 (LBS)
	A	B	C	E	F		
2 1/2	1/2	3 3/8	4 13/16	2 1/4	1 5/16	970	28
3	1/2	3 3/4	5 9/16	2 5/8	1 3/8	970	38
4	1/2	4 5/8	6 15/16	3 7/16	1 11/16	1250	60
5	1/2	5 1/16	7 7/8	3 15/16	1 5/8	1250	70
6	3/4	6 3/8	9 3/4	4 3/4	2 3/16	1600	134
8	3/4	8 1/16	12 7/16	6 7/16	2 7/8	1800	164

QWI 4.3.1 Issue Date Nov/21 Rev.3