

#94 Roller Chair - Short

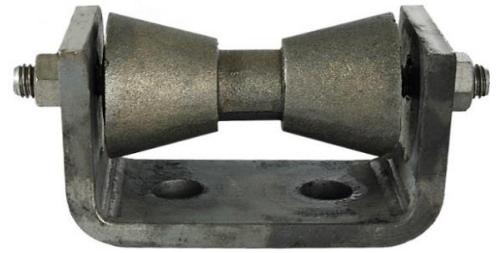

Finishes Bare Metal, Zinc Plated, Hot Dipped Galvanized

Materials Cast Iron Roller with Carbon Steel yoke and hardware, Stainless Steel 304SS & 316SS

Approvals Complies with MSS SP-58 and SP-69 (Type 44)

Recommended Pipe support designed for pipe lines where horizontal movement may take place due to expansion and contraction.

Two holes are provided for bolting or the steel base may be welded directly to the supporting steel.

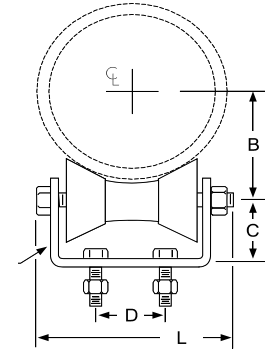

IRON PIPE SIZE	SPECIFICATION DATA								RECOM. MAX. LOAD (LBS)	APP'X WT. PER 100 (LBS)
	B					C	D	L		
2 - 3 1/2	For Size	2"	2 1/2"	3"	3 1/2"	1 3/4	1 3/8	4 1/2	390	215
	B =	1 3/4	2 1/8	2 3/8	2 5/8					
4 - 6	For Size		4"	5"	6"	2 1/16	2	6 1/8	950	410
	B =		2 3/4	3 3/8	4					
8 - 10	For Size			8	10	3 7/16	4	8 3/4	2100	1060
	B =			5 1/4	6 3/8					
12 - 14	For Size			12"	14"	3 7/8	5 3/4	11 1/4	3075	2130
	B =			7 1/2	8 1/8					
16 - 20	For Size		16"	18"	20"	4 1/4	6 3/4	12 1/2	4980	2895
	B =		9 3/8	10 3/8	11 3/8					
22 - 24	For Size				24"	4 3/8	6 1/2	15	6100	3820
	B =				13 3/8					
26 - 30	For Size				30"	5 1/8	9	19	7500	7025
	B =				16 3/4					

QWI 4.3.1 Issue Date Dec/22 Rev.11

Note: when referencing a printed copy of this specification page, please insure it is the latest version as found on our website at www.taylorwalraven.ca

For more information, please contact Customer Service at 1-800-263-8652