

**Finishes** Bare Metal, Zinc Plated, Hot Dipped Galvanized

**Materials** Carbon Steel, Stainless Steel 304SS & 316SS

**Recommended** Designed as a heavy duty washer to suspend hanger rods.

Maximum temperatures: Plain 750°F, Galvanized 450°F

**Notes** Other sizes available upon request

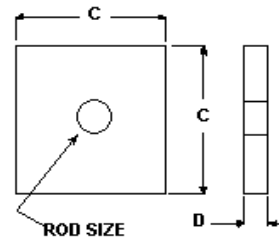

Rod Size	PLATE SIZE D x C x C	Hole Dia.	Wt Each	Max Load	
				650 F	750 F
3/8	3/16" x 3" x 3"	7/16	0.5	-	-
1/2		9/16	0.4	-	-
3/8	1/4" x 2" x 2"	7/16	0.3	-	-
1/2		9/16	0.3	-	-
3/8	1/4" x 3" x 3"	7/16	0.6	730	572
1/2		9/16	0.6	1350	1057
5/8	3/8" x 3" x 3"	11/16	0.9	2160	1692
5/8	3/8" x 4" x 4"	11/16	1.7	-	-
3/4		13/16	1.7	3230	2530
7/8		15/16	1.6	-	-
1		1 1/8	1.6	-	-
7/8	1/2" x 4" x 4"	15/16	2.2	4480	3508
1		1 1/8	2.1	5900	4620
1 1/4	1/2" x 5" x 5"	1 3/8	3.3	9500	7440
1 1/2	3/4" x 5" x 5"	1 3/4	4.8	13800	10807
1 3/4		2	4.7	18600	14566
2		2 1/4	4.5	24600	19265
2 1/4	3/4" x 6" x 6"	2 1/2	6.6	32300	25295
2 1/2		2 3/4	6.4	39800	31169
2 3/4		3	6.2	49400	38687
3		3 1/4	5.9	60100	47066
3 1/4		3 1/2	5.6	71900	56307
3 1/2	3/4" x 7" x 7"	3 3/4	8.1	84700	66331
3 3/4		4	7.8	98500	77139

QWI 4.3.1 Issue Date Apr/2023 Rev.8

Note: when referencing a printed copy of this specification page, please insure it is the latest version as found on our website at [www.taylorwalraven.ca](http://www.taylorwalraven.ca)

For more information, please contact Customer Service at 1-800-263-8652