

#41SS Swivel Ring Hanger

Finishes Bare Metal

Materials Stainless Steel 304SS & 316SS
See #41 for Carbon Steel Specifications

Recommended for the suspension of non-insulated stationary pipe lines allowing for vertical adjustment.

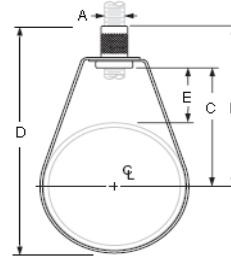

IRON PIPE SIZE	SPECIFICATION DATA					REC. MAX LOAD (LBS)	APP'X WT. PER 100 (LBS)
	A	B	C	D	E		
1/2	3/8	2 13/16	1 15/16	3 1/4	1 9/16	610	9
3/4	3/8	2 3/4	1 7/8	3 1/4	1 5/16	610	9
1	3/8	2 7/8	2	3 1/2	1 5/16	610	9
1 1/4	3/8	3	2 1/8	3 13/16	1 1/4	610	10
1 1/2	3/8	3 1/8	2 1/4	4 1/16	1 1/4	610	11
2	3/8	3 7/16	2 9/16	4 5/8	1 3/8	610	12
2 1/2	3/8	4	3 1/8	5 7/16	1 11/16	610	28
3	3/8	4 5/16	3 7/16	6 1/16	1 11/16	610	30
4	3/8	4 1/8	3 1/4	6 3/8	1	610	37
5	1/2	6 3/8	5 1/4	9 5/16	2 5/16	610	83
6	1/2	7 3/16	6 1/8	10 1/2	2 13/16	610	95

QWI 4.3.1 Issue Date Aug/23 Rev.0

Note: when referencing a printed copy of this specification page, please insure it is the latest version as found on our website at www.taylorwalraven.ca

For more information, please contact Customer Service at 1-800-263-8652